



MIXED FLOW





MIXED FLOW ABOVE GRADE

APPLICATIONS:

- Transfer & supply water from lakes, rivers, retention ponds, geothermals & aquifers
- Potable Water
- Irrigation
- High Volume Booster
- Waste Water
- Flood Control
- Dewatering

Flows: up to 24,000 gpm

Total Dynamic Head: 0 - 200 feet

Discharge Designs: Above or Below Surface

STANDARD FEATURES:

- Standard Bronze or Stainless Steel Impellers
- Standard all Stainless Steel Bolting & Collets
- Standard Specialty bearings

ADDITIONAL FEATURES:

- Low NPSH Design
- Solids passage 1.5" to 4" depending on model
- Floating stations available

Material options for use with clean water, salt water, mine water, brines, and corrosives.

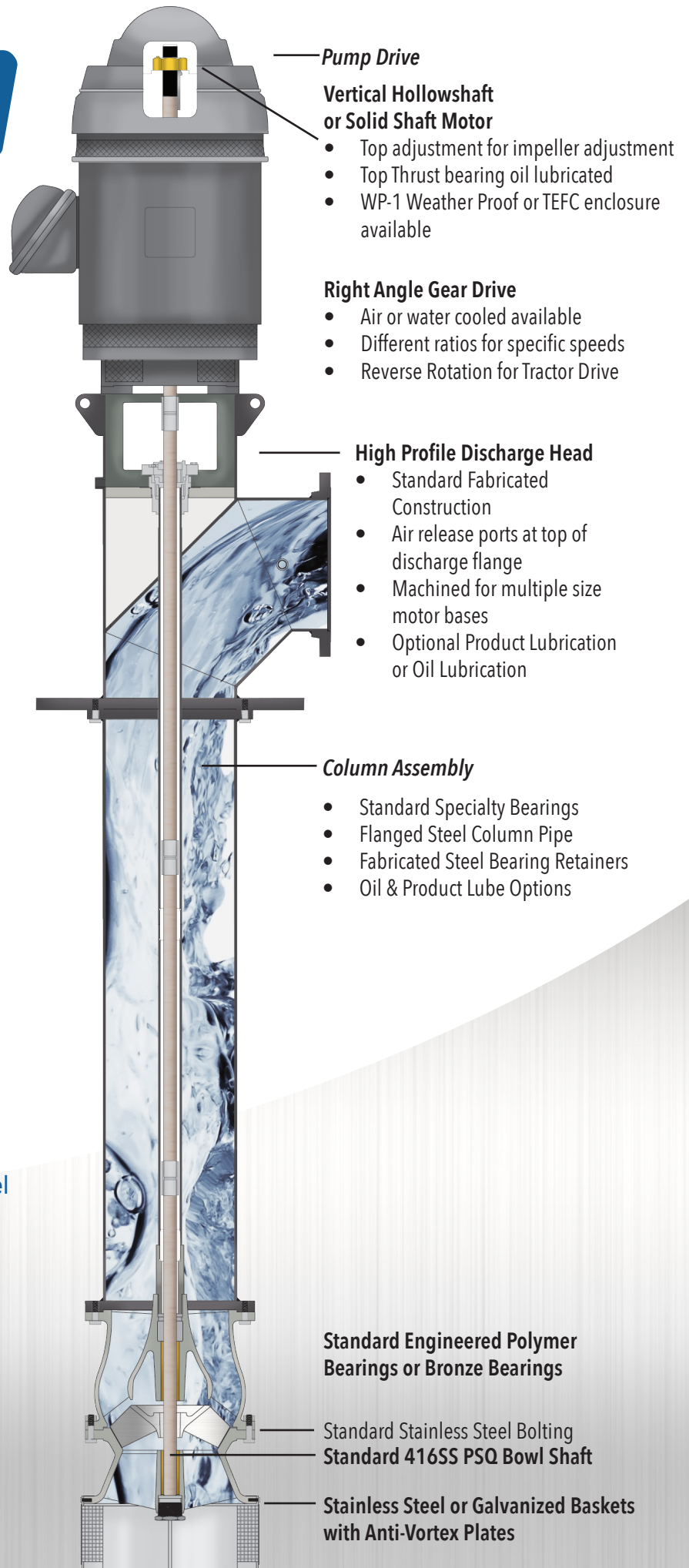



CONTRACTOR:
ENGINEER:

GPM TDH HP EFFIC.
SERVICE CONDITION: **STAGES**

MODEL
NPP-6MFH

RPM
1760

END USER: **PROJECT:**

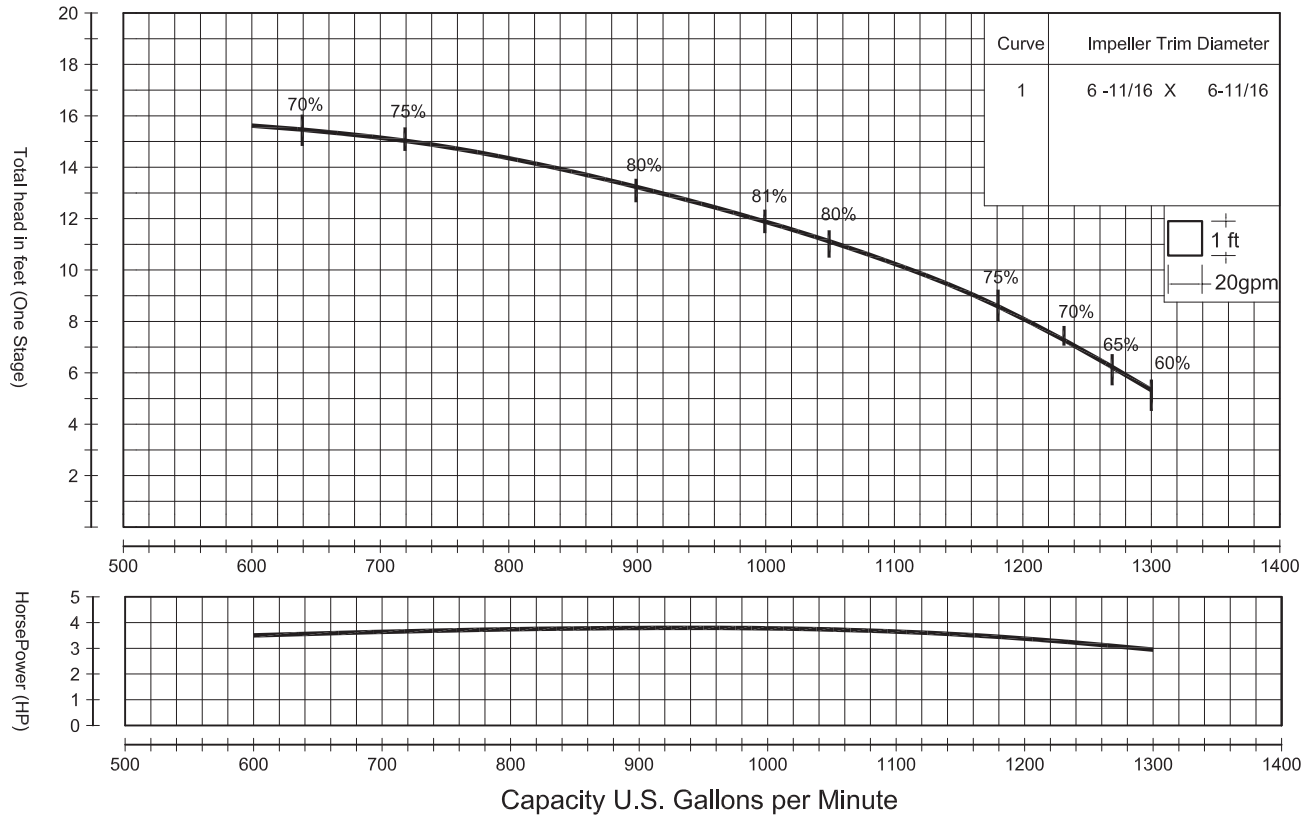

Std. Shaft Diameter	1.188"	Impeller WT- LB	3.300
Max. Shaft Diameter	1.188"	One Stage WR ² LB-FT ²	N/A
Std. Lateral Setting	.750"	Impeller Type	SEMIOPEN
Max. Lateral Setting	.1875"	Impeller No.	TAT1413
Discharge Sizes	6"	Max. Sphere Size	N/A
Suction Sizes	6"	K-Factor, Max.	N/A
One Stage Subm. WT-LB	N/A	Max. Operating P.S.I	350
One Stage Water Lube WT-LB	88.405	Min. Submergence	N/A
One Stage Oil Lube WT-LB	102.51	Impeller Eye Area IN ²	N/A
Add. Stage WT- LB	30.196	Specific Speed	N/A

pumpandpond.com

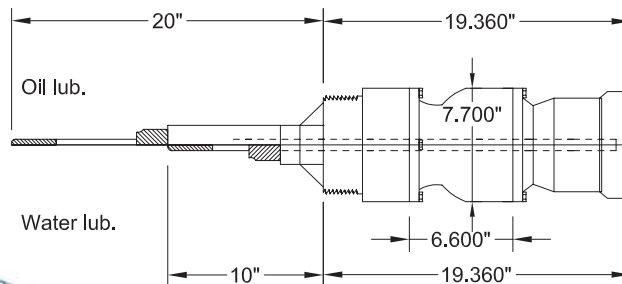



CONTRACTOR:
ENGINEER:

GPM **TDH** **HP** **EFFIC.**
SERVICE CONDITION: **STAGES**

MODEL
NPP8MFH

END USER:

PROJECT:

RPM
1760

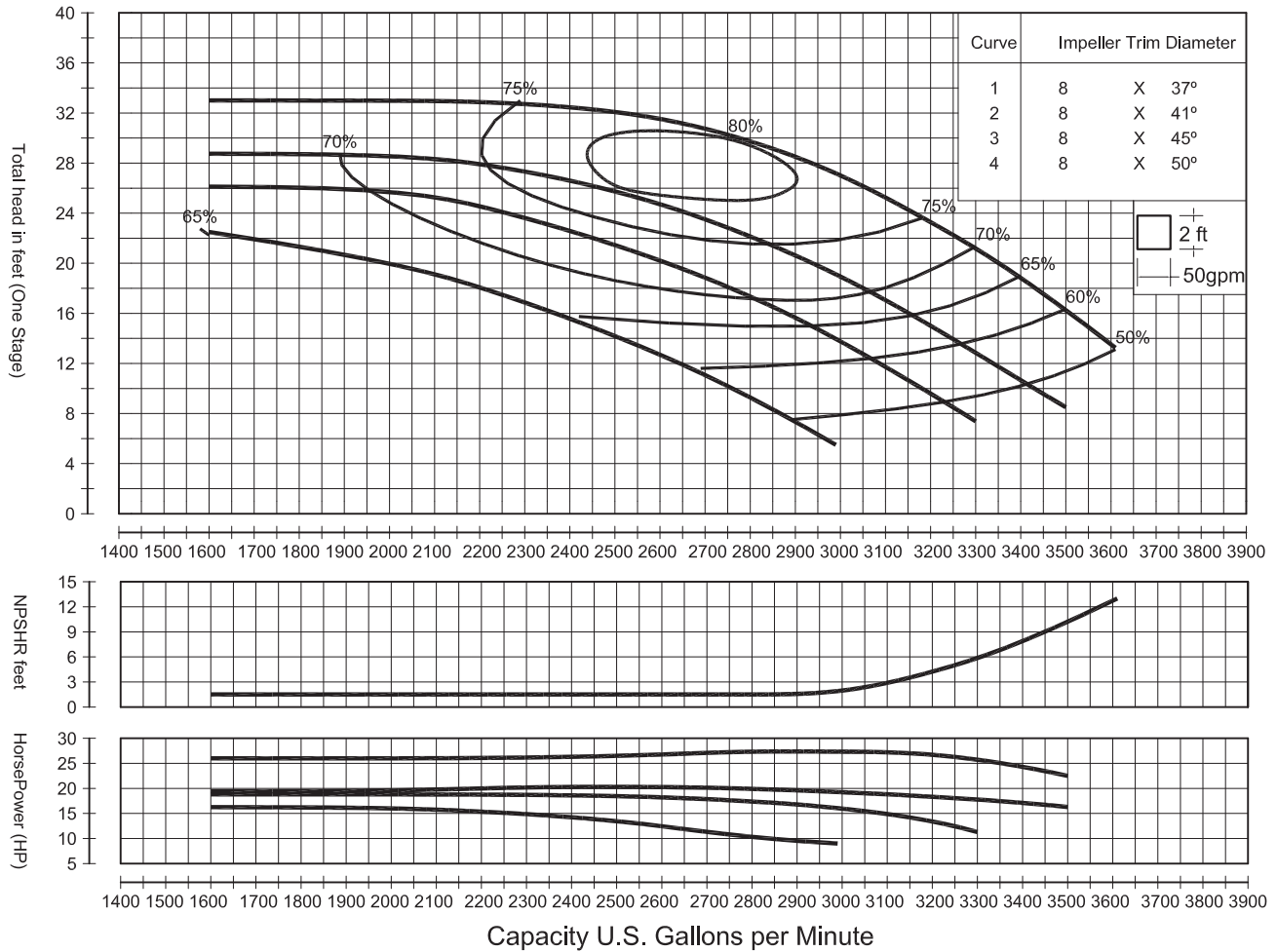

Std. Shaft Diameter	1.000"
Max. Shaft Diameter	1.188"
One Stage WT-LB	128.39
Add. Stage WT- LB	100.43
Impeller WT- LB	8.800
One Stage WR ² LB-FT ²	32
Impeller Type	SEMIOPEN
Impeller No.	TAT1414
Max. Sphere Size	1.500
K-Factor, Max.	17.600
Max. Operating P.S.I	100
Min. Submergence	18"
Bolt Holes	8
Bolt Holes Diameter	.500

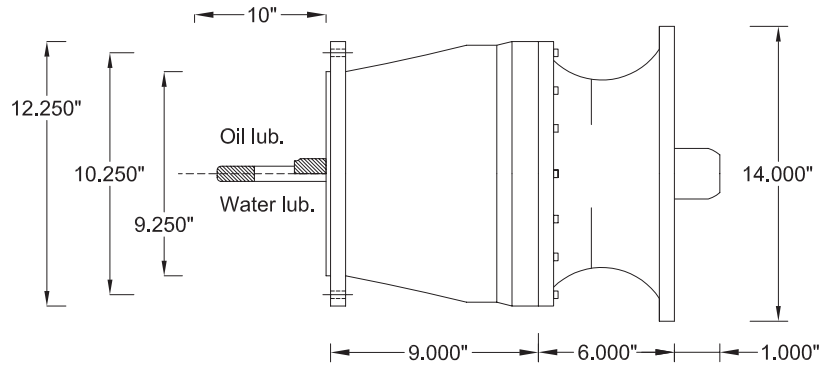



CONTRACTOR:
ENGINEER:

GPM TDH HP EFFIC.
SERVICE CONDITION: **STAGES**

MODEL
NPP10MFH

END USER:

PROJECT:

RPM
1760

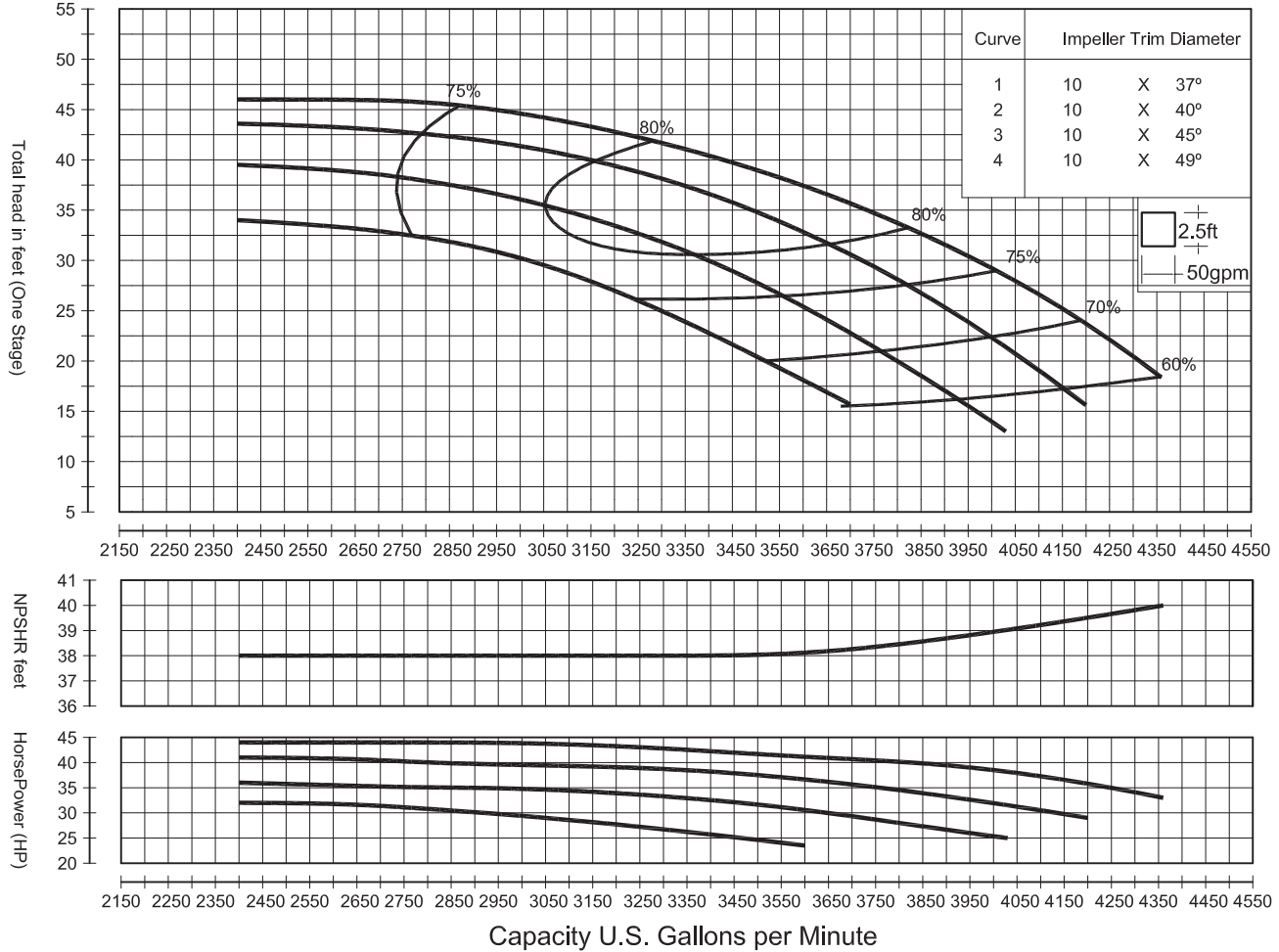

Std. Shaft Diameter	1.188"
Max. Shaft Diameter	1.500"
One Stage WT-LB	153.29
Add. Stage WT- LB	134.61
Impeller WT- LB	14.520
One Stage WR ² LB-FT ²	72
Impeller Type	SEMIOPEN
Impeller No.	TAT1415
Max. Sphere Size	1.625
K-Factor, Max.	25
Max. Operating P.S.I	100
Min. Submergence	16"
Bolt Holes	8
Bolt Holes Diameter	.625

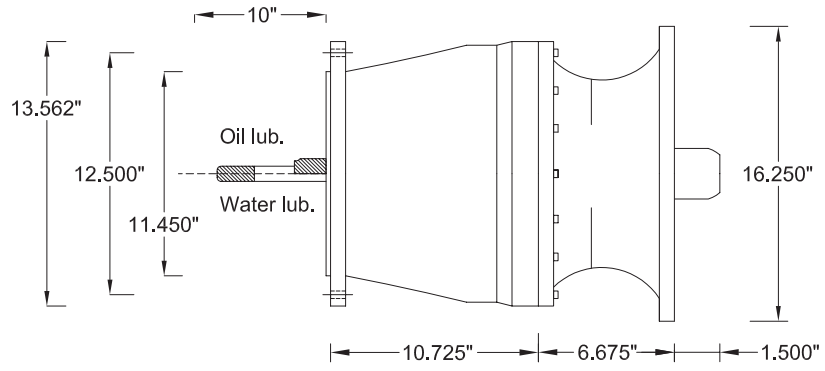



CONTRACTOR:
ENGINEER:

GPM TDH HP EFFIC.
SERVICE CONDITION: **STAGES**

MODEL
NPP12MFL

END USER:

PROJECT:

RPM
1760

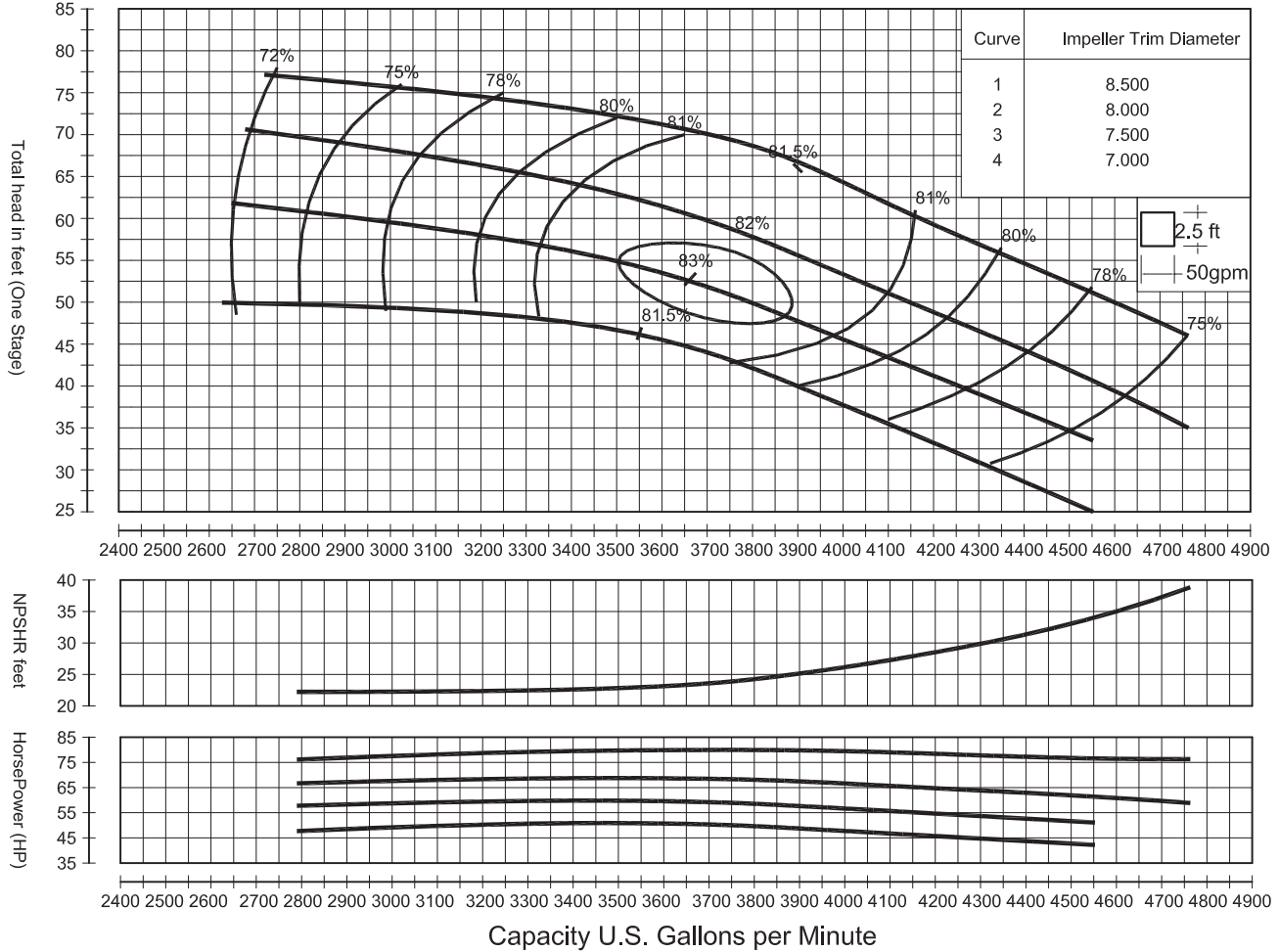

Std. Shaft Diameter	1.688"
Max. Shaft Diameter	1.938"
One Stage WT-LB	187.61
Add. Stage WT- LB	155.82
Impeller WT- LB	25.500
One Stage WR ² LB-FT ²	72
Impeller Type	SEMIOPEN
Impeller No.	TAT1416
Max. Sphere Size	1.625
K-Factor, Max.	23
Max. Operating P.S.I	100
Min. Submergence	33"
Bolt Holes	12
Bolt Holes Diameter	.500

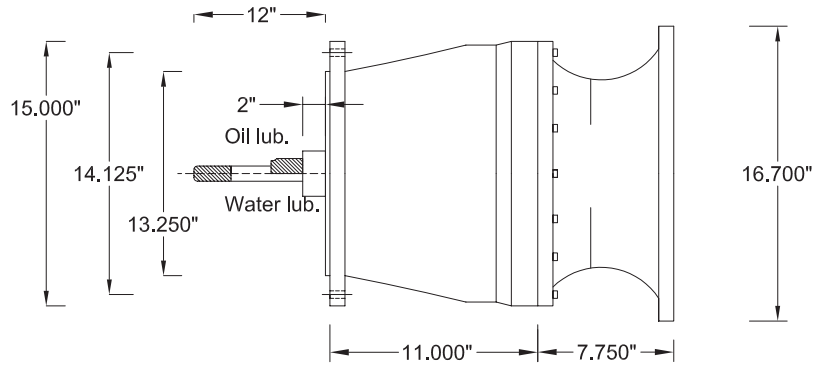

pumpandpond.com



CONTRACTOR:
ENGINEER:

GPM TDH HP EFFIC.
SERVICE CONDITION: **STAGES**

MODEL
NPP12MFH

END USER:

PROJECT:

RPM
1760

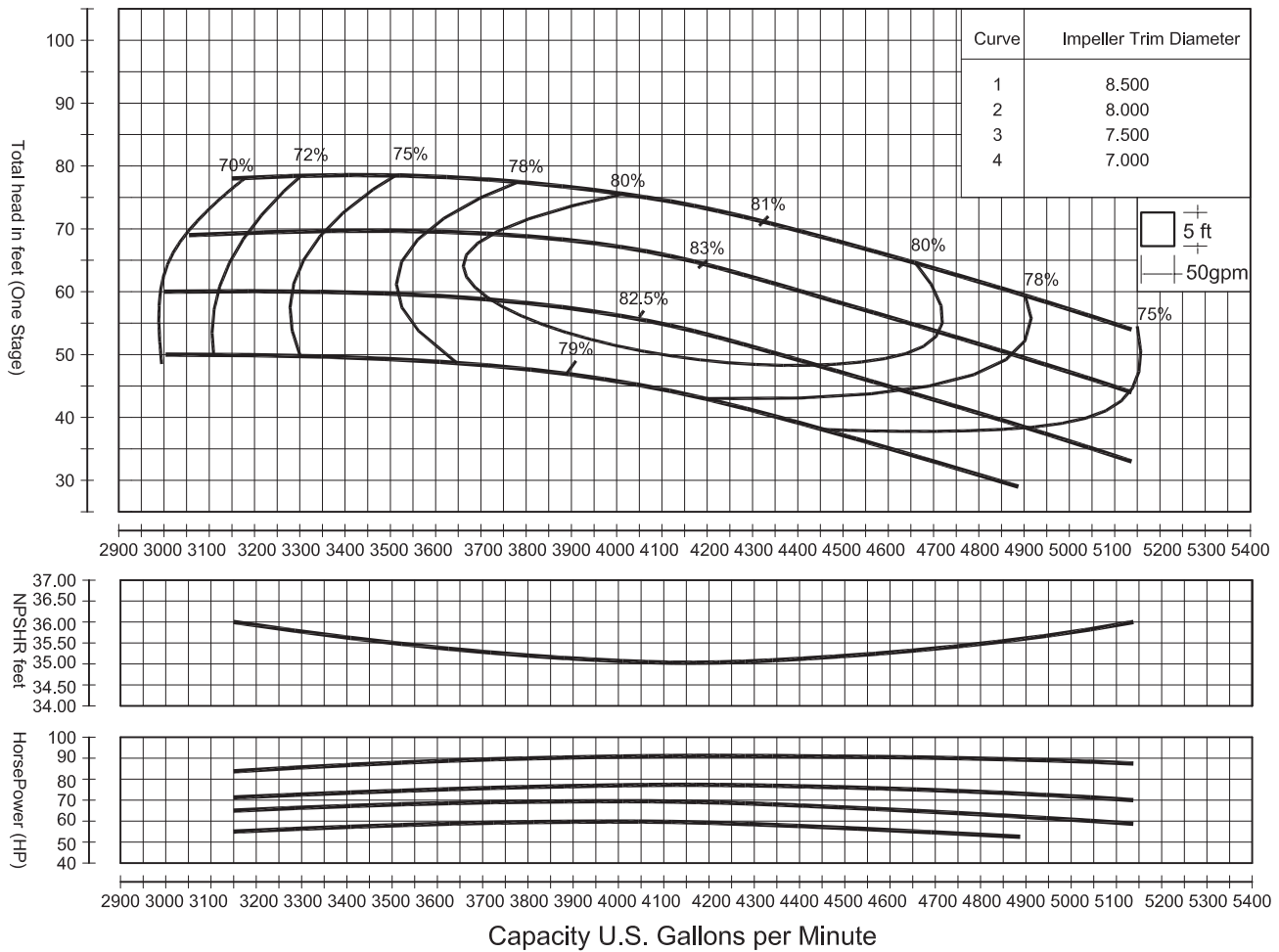

Std. Shaft Diameter	1.688"
Max. Shaft Diameter	1.938"
One Stage WT-LB	183.11
Add. Stage WT- LB	151.32
Impeller WT- LB	21.000
One Stage WR ² LB-FT ²	72
Impeller Type	SEMIOPEN
Impeller No.	TAT1426
Max. Sphere Size	1.625
K-Factor, Max.	23
Max. Operating P.S.I	100
Min. Submergence	33"
Bolt Holes	12
Bolt Holes Diameter	.500

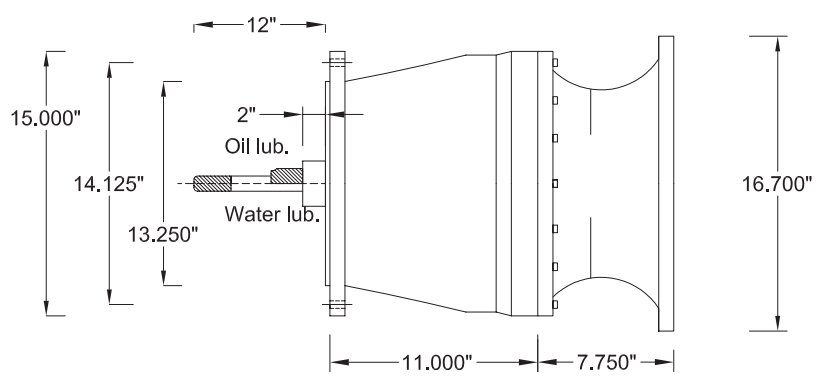

pumpandpond.com



CONTRACTOR:
ENGINEER:

GPM TDH HP EFFIC.
SERVICE CONDITION: **STAGES**

MODEL
NPP12MFL

END USER:

PROJECT:

RPM
1180

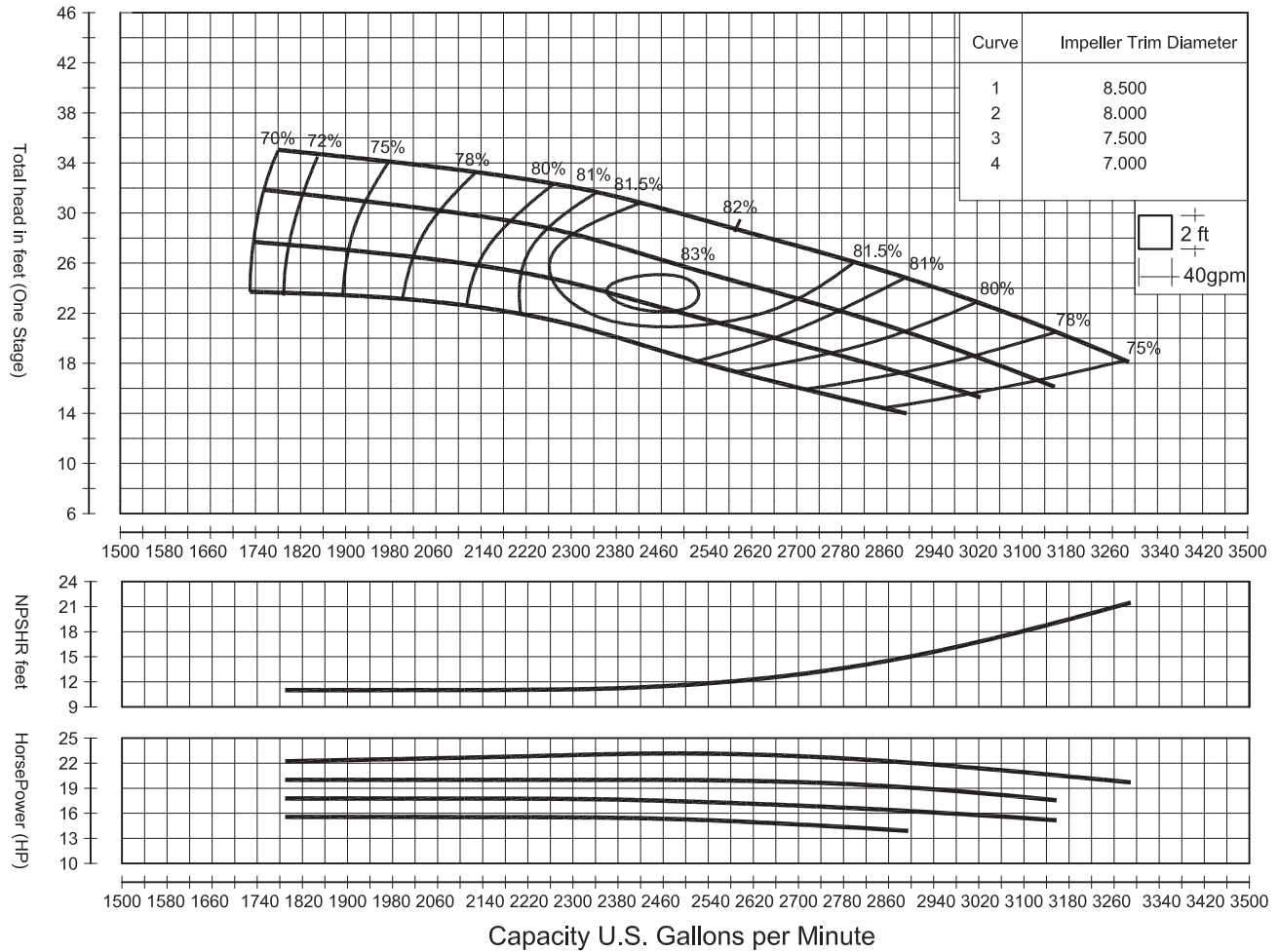

Std. Shaft Diameter	1.688"
Max. Shaft Diameter	1.938"
One Stage WT-LB	187.61
Add. Stage WT- LB	155.82
Impeller WT- LB	25.500
One Stage WR ² LB-FT ²	72
Impeller Type	SEMIOPEN
Impeller No.	TAT1416
Max. Sphere Size	1.625
K-Factor, Max.	23
Max. Operating P.S.I	100
Min. Submergence	33"
Bolt Holes	12
Bolt Holes Diameter	.500

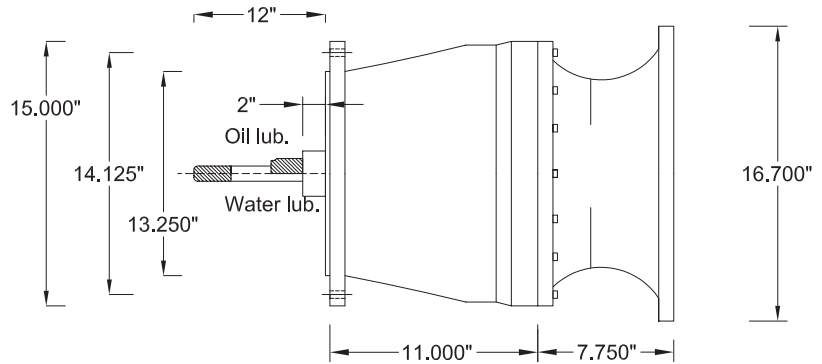



CONTRACTOR:
ENGINEER:

GPM TDH HP EFFIC.
SERVICE CONDITION: **STAGES**

MODEL
NPP12MFH

END USER:

PROJECT:

RPM
1180

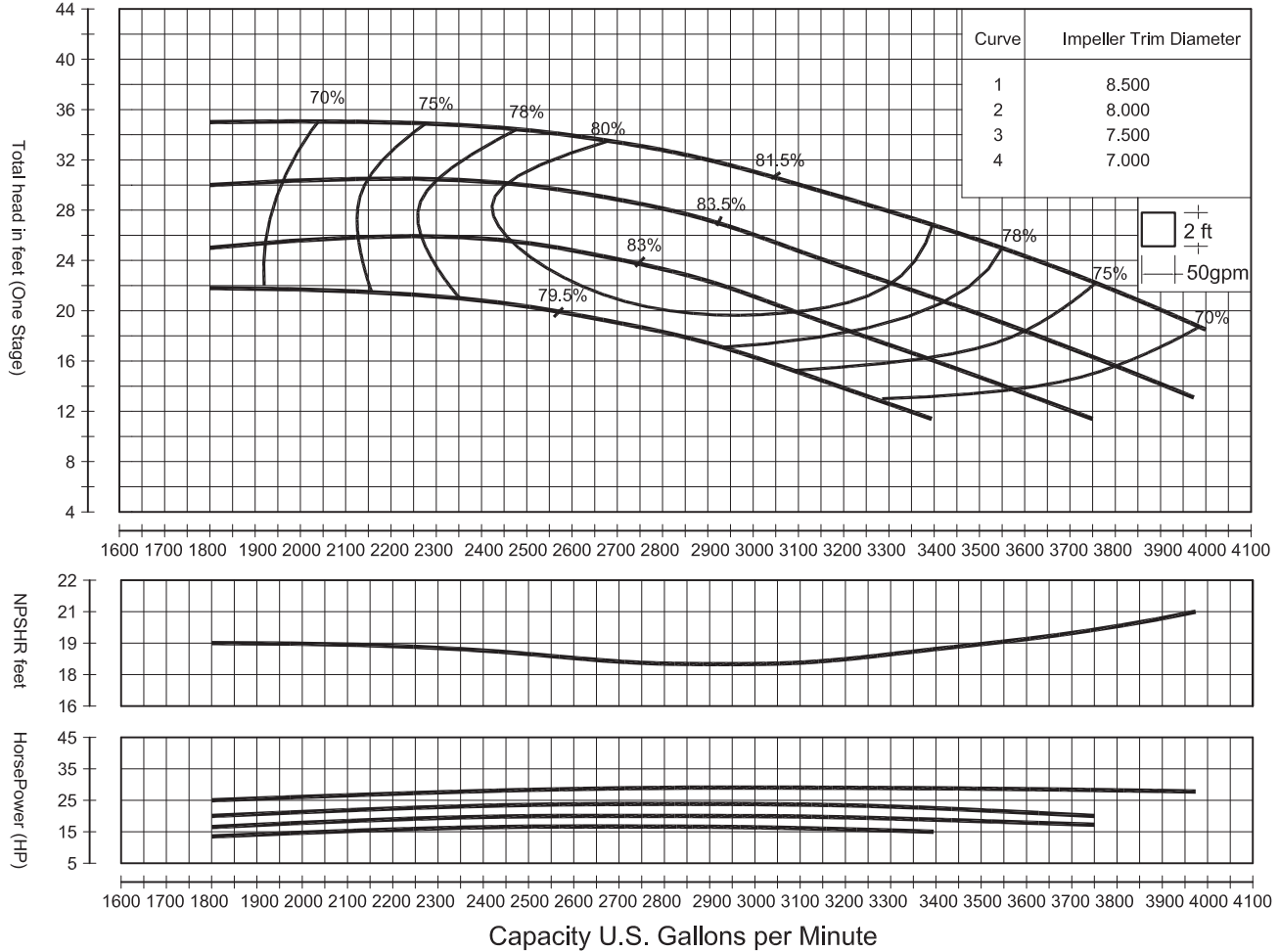

Std. Shaft Diameter	1.688"
Max. Shaft Diameter	1.938"
One Stage WT-LB	183.11
Add. Stage WT- LB	151.32
Impeller WT- LB	21.000
One Stage WR ² LB-FT ²	72
Impeller Type	SEMIOPEN
Impeller No.	TAT1426
Max. Sphere Size	1.625
K-Factor, Max.	23
Max. Operating P.S.I	100
Min. Submergence	33"
Bolt Holes	12
Bolt Holes Diameter	.500

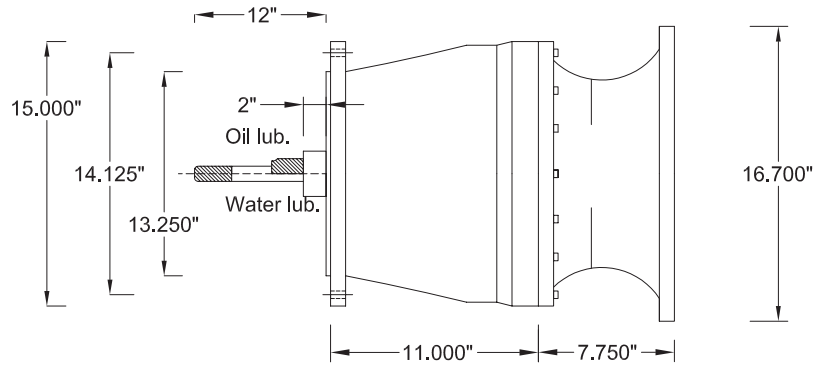

pumpandpond.com



CONTRACTOR:
ENGINEER:

GPM TDH HP EFFIC.
SERVICE CONDITION: **STAGES**

MODEL
NPP16MFL
RPM
1180

END USER: **PROJECT:**

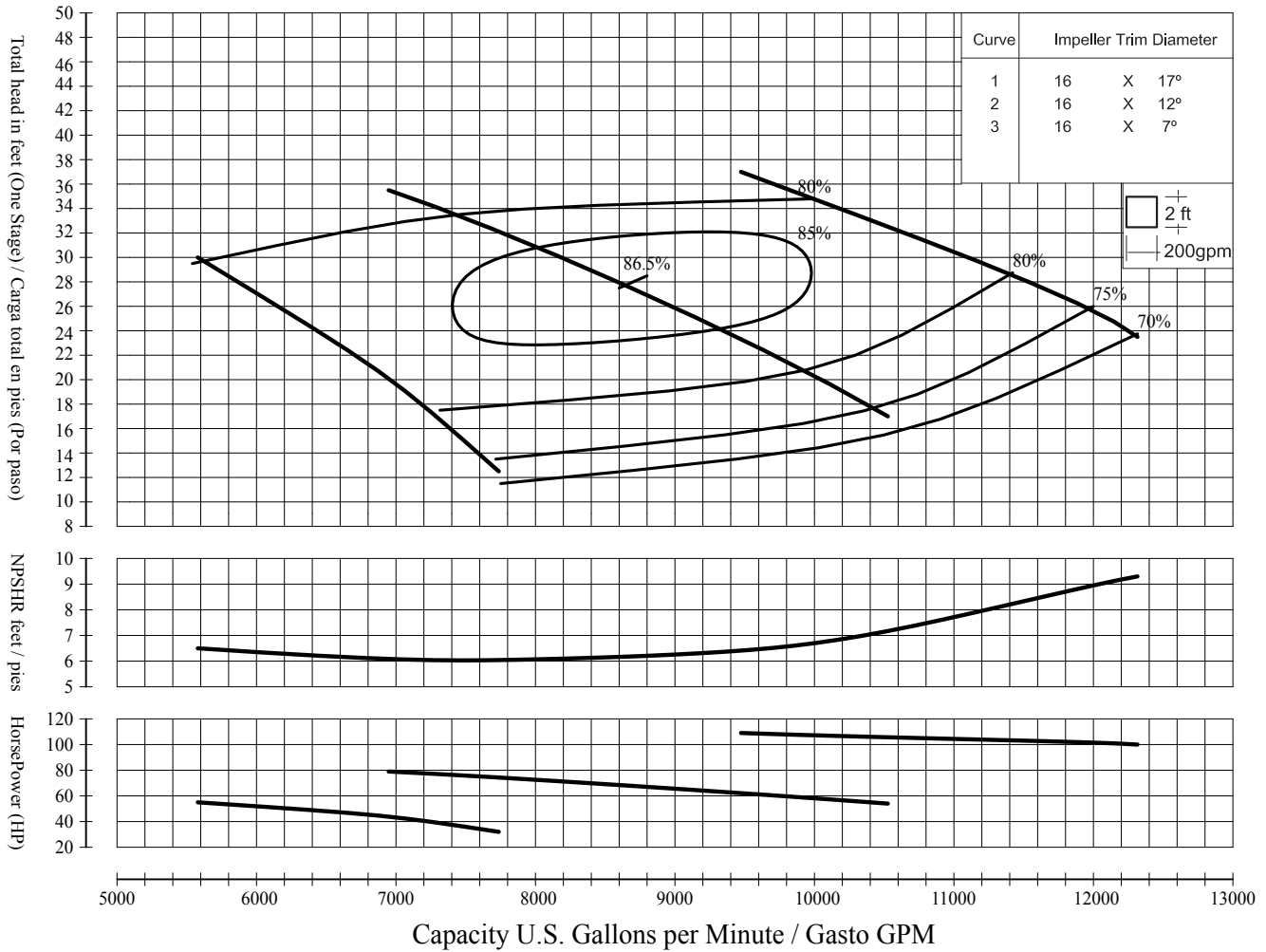

Std. Shaft Diameter	1.938"
Max. Shaft Diameter	2.000"
One Stage WT-LB	451.24
Add. Stage WT- LB	388.85
Impeller WT- LB	46.000
One Stage WR ² LB-FT ²	N/A
Impeller Type	SEMIOPEN
Impeller No.	TAT1418
Max. Sphere Size	2.250"
K-Factor, Max.	N/A
Max. Operating P.S.I	100
Min. Submergence	32"
Bolt Holes	16
Bolt Holes Diameter	.875

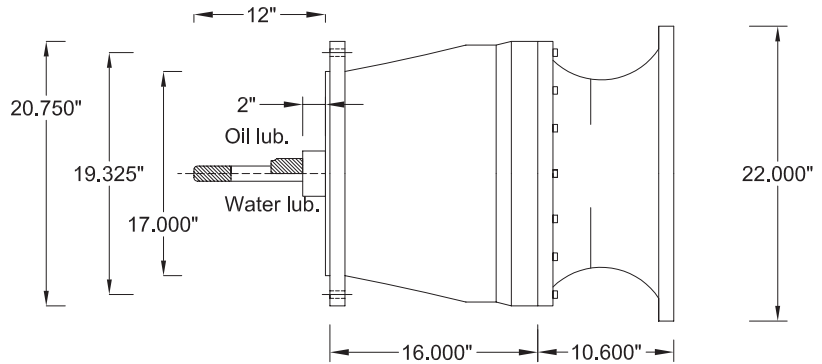



CONTRACTOR:
ENGINEER:

GPM TDH HP EFFIC.
SERVICE CONDITION: **STAGES**

MODEL
NPP16MFH

END USER:

PROJECT:

RPM
1180

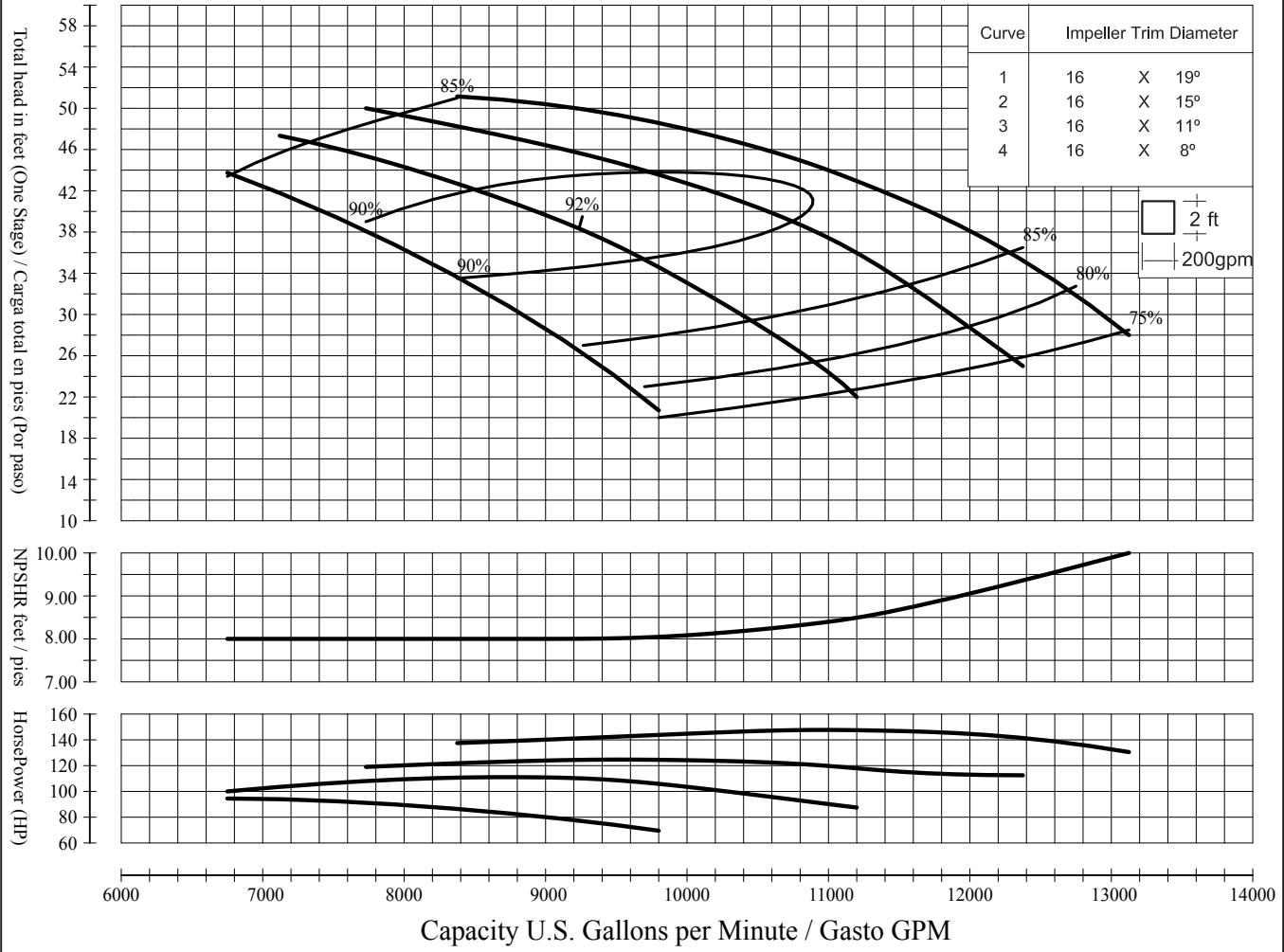

Std. Shaft Diameter	1.938"
Max. Shaft Diameter	2.000"
One Stage WT-LB	451.24
Add. Stage WT- LB	388.85
Impeller WT- LB	46.000
One Stage WR ² LB-FT ²	N/A
Impeller Type	SEMIOPEN
Impeller No.	TAT1428
Max. Sphere Size	2.250"
K-Factor, Max.	N/A
Max. Operating P.S.I	100
Min. Submergence	32"
Bolt Holes	16
Bolt Holes Diameter	.875

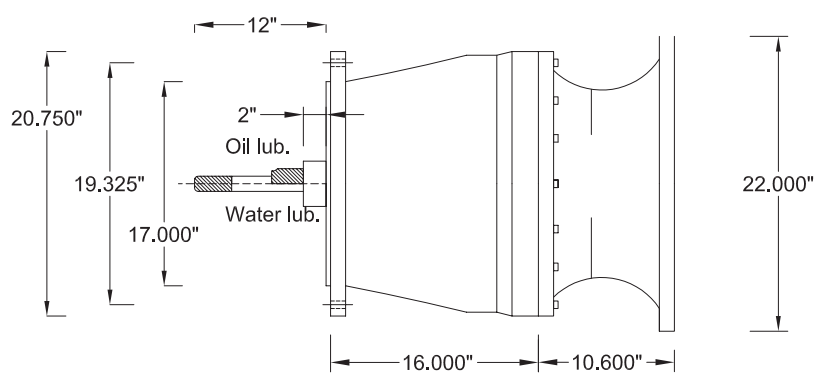



CONTRACTOR:
ENGINEER:

GPM TDH HP EFFIC.
SERVICE CONDITION: **STAGES**

MODEL
NPP16MFL

END USER:

PROJECT:

RPM
880

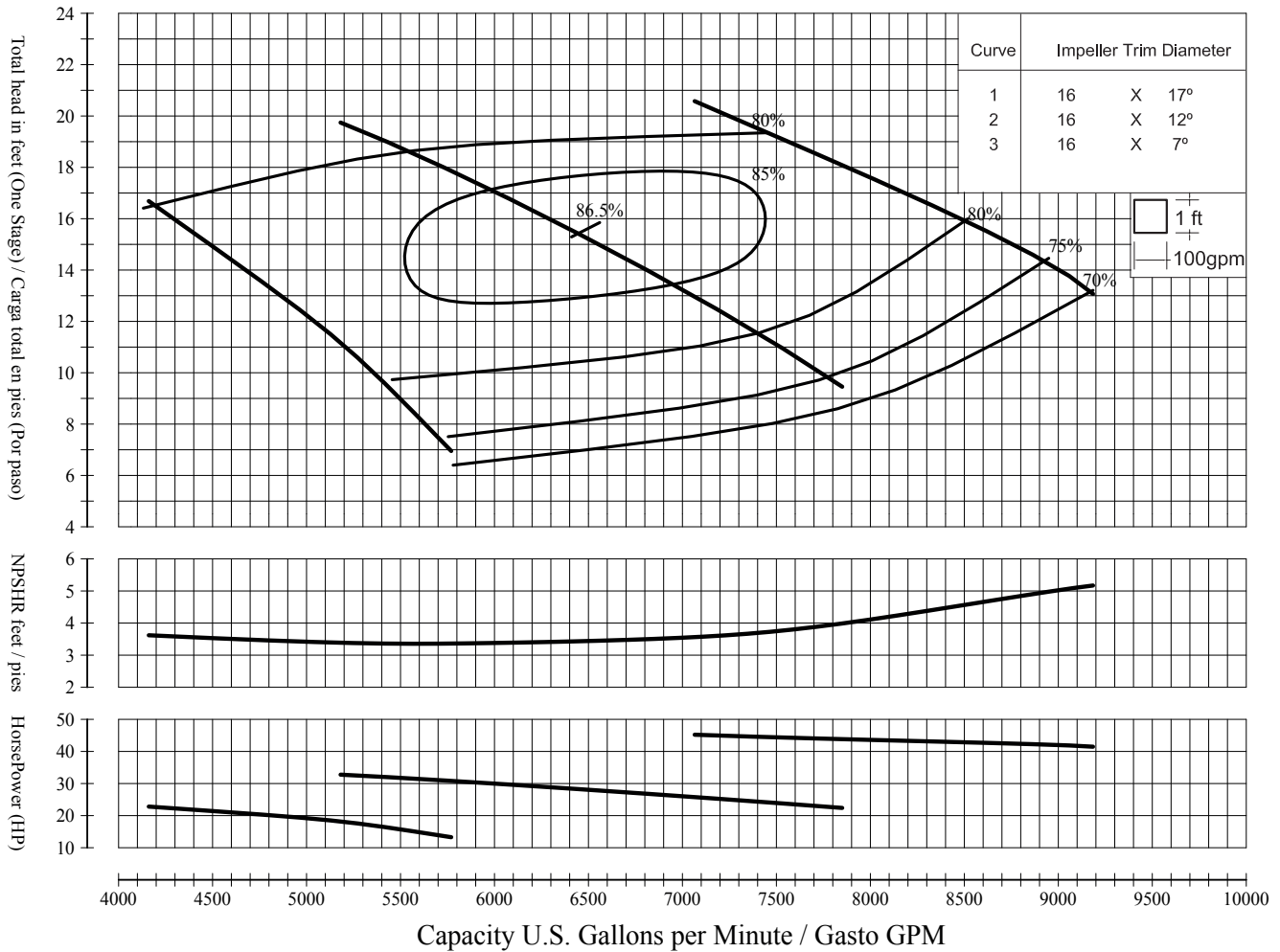

Std. Shaft Diameter	1.938"
Max. Shaft Diameter	2.000"
One Stage WT-LB	451.24
Add. Stage WT- LB	388.85
Impeller WT- LB	46.000
One Stage WR ² LB-FT ²	N/A
Impeller Type	SEMIOPEN
Impeller No.	TAT1418
Max. Sphere Size	2.250"
K-Factor, Max.	N/A
Max. Operating P.S.I	100
Min. Submergence	32"
Bolt Holes	16
Bolt Holes Diameter	.875

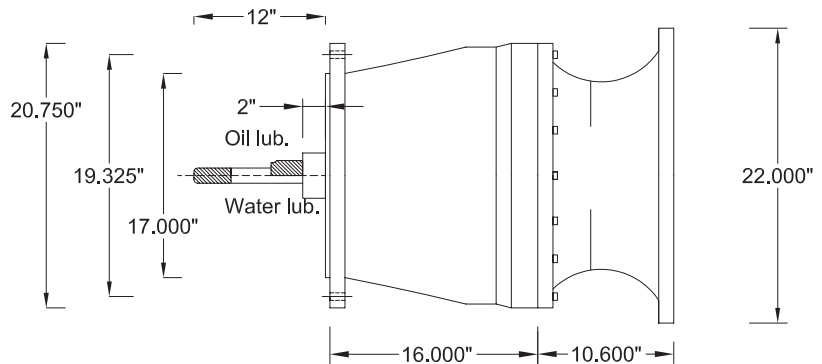



CONTRACTOR:
ENGINEER:

GPM TDH HP EFFIC.
SERVICE CONDITION: **STAGES**

MODEL
NPP16MFH
RPM
880

END USER: **PROJECT:**

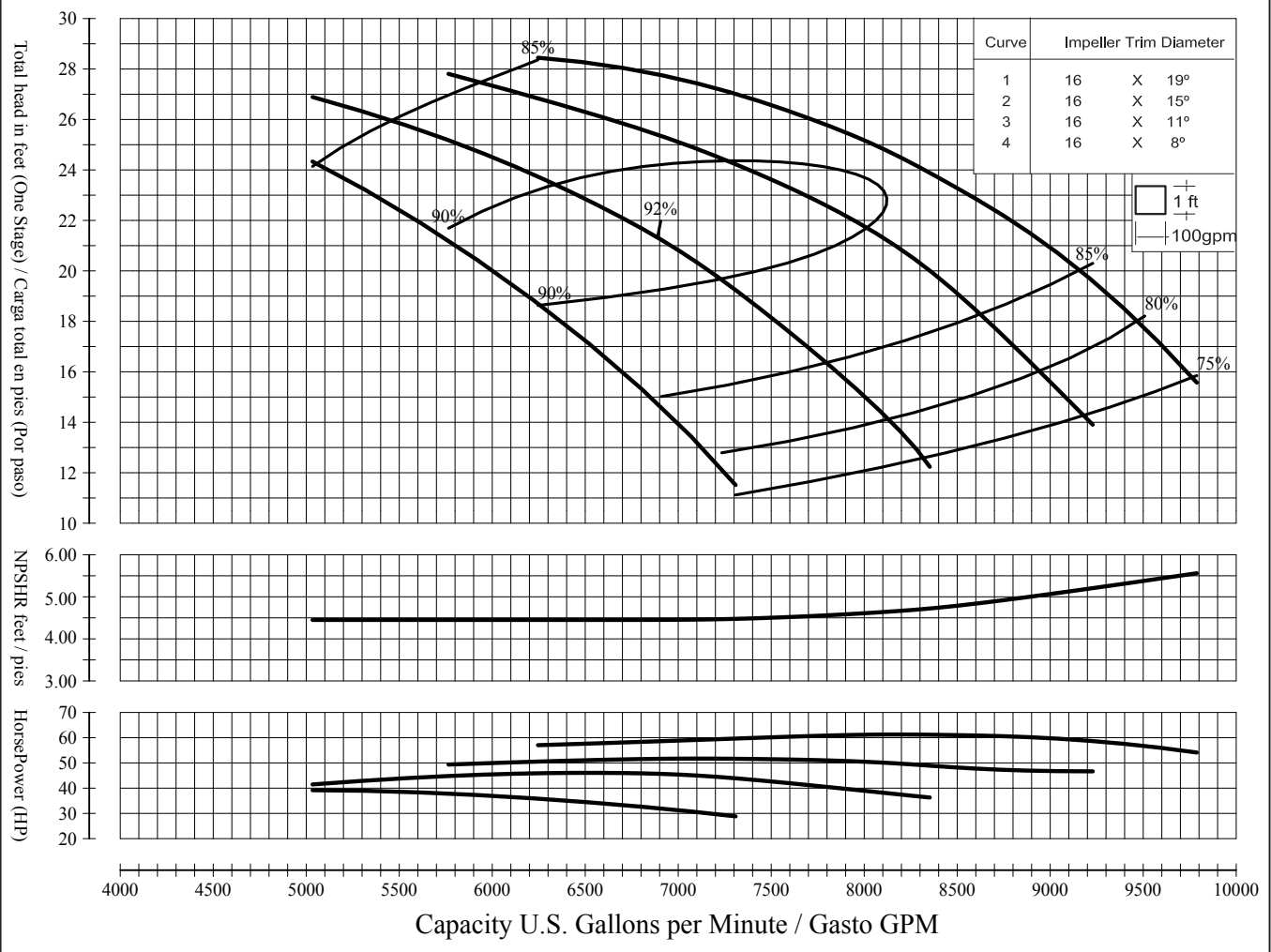

Std. Shaft Diameter	1.938"
Max. Shaft Diameter	2.000"
One Stage WT-LB	451.24
Add. Stage WT- LB	388.85
Impeller WT- LB	46.000
One Stage WR ² LB-FT ²	N/A
Impeller Type	SEMIOPEN
Impeller No.	TAT1428
Max. Sphere Size	2.250"
K-Factor, Max.	N/A
Max. Operating P.S.I	100
Min. Submergence	32"
Bolt Holes	16
Bolt Holes Diameter	.875

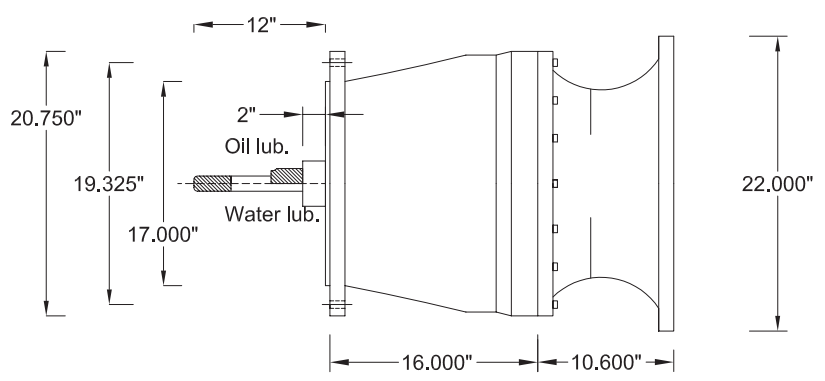

pumpandpond.com

VERTICAL TURBINE PUMPS AND FLOATING PLATFORMS



Pipe line float carrying 18" pipe from pump



Large vertical pump with walkway.



3 pumps on 3 floating platforms attached together.



PIPE LINE FLOAT

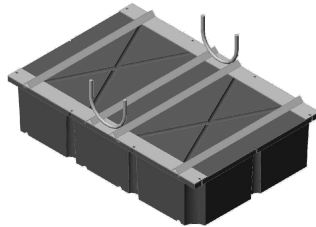
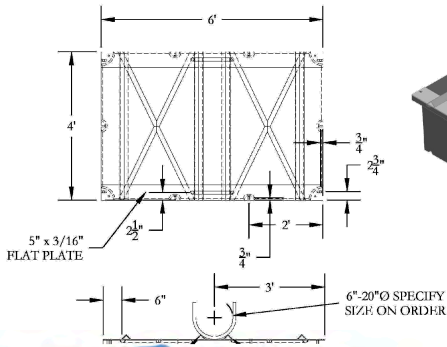

Nashville Pump & Pond pipe line float can be made to accommodate most size pipes. It is a simple, effective way to support a pipe from your pump to land. The frame is hot dipped galvanized after fabrication, frame bolts directly to a float.

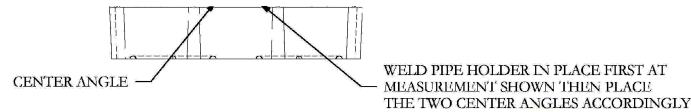

FLOATING WALKWAYS

Nashville Pump & Pond floating walkways are available in many different lengths and come complete with handrail and our press lock decking (page 32). The standard width that works best with our pump docks is 4'. The section shown below is a 4' x 40' section. Sections can pin or bolt together in 10' increments to allow for easy assembly on site.



VERTICAL TURBINE PUMPS AND FLOATING PLATFORMS

Nashville Pump & Pond 12' x 12' and 16' x 16' vertical pump docks can support 200-500 HP pumps for agriculture, water and waste water applications. The 2 sections of this rugged steel platform can be easily bolted together on site. Comes complete with floats, Galvanized Press

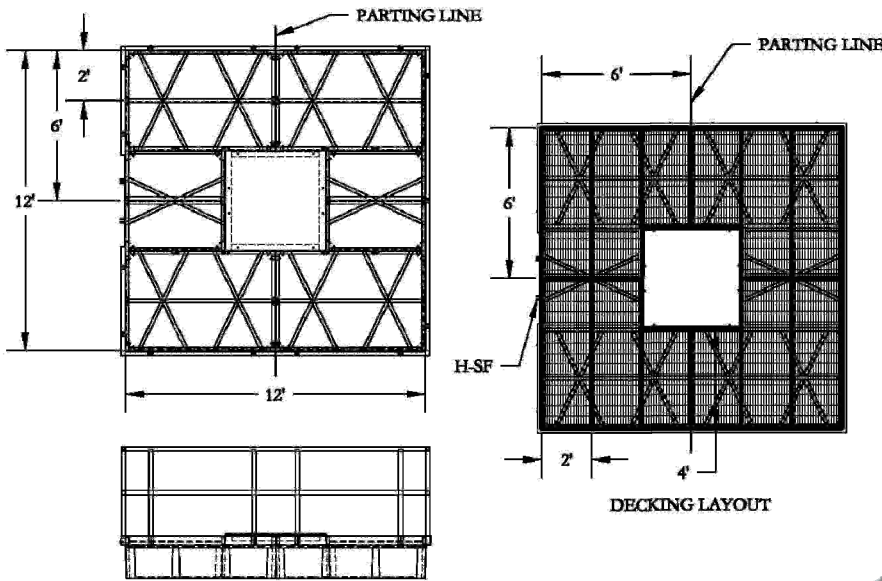

Lock Decking and plate for pump. Entire unit is hot dipped galvanized for long service. The base unit has 9950# of flotation. Walkways and other accessories are also available. Ships preassembled. The frame is made from 4" x 7.25 channel and hot dipped galvanized after fabrication. The handrail is 2" galvanized pipe fit together with Hollaender aluminum/ magnesium fittings. The center 3/8" x 4' x 4' plate is bolted to the frame. The plate is galvanized but has no hole so the customer can cut the correct hole for the pumps being used or send us your hole pattern drawing and we will cut holes to your specs at no additional charge. Call for complete details and pricing.

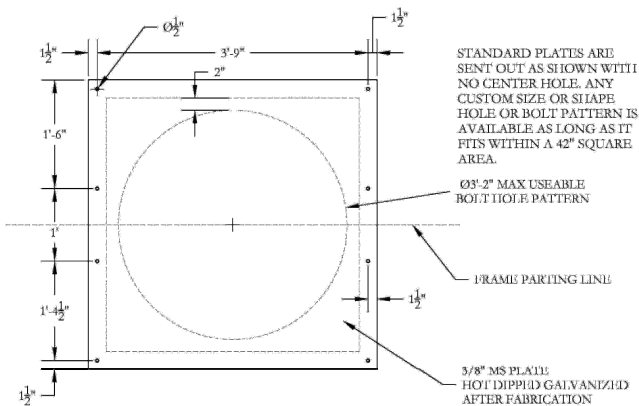
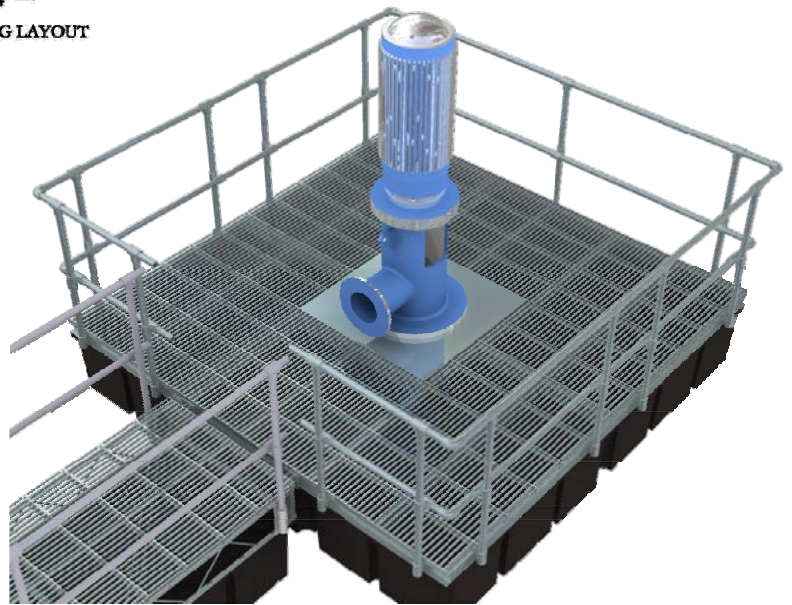

Our press lock decking comes standard (already included) on our vertical pump floating platform but can be purchased individually as shown below. These are industrial strength galvanized steel panels, great for high traffic or commercial needs. These are ideal for walkways and ramps. Allows for 65% sunlight penetration.

Ramps to dock, extensions of ramps and other size platforms can be constructed. Call one of our knowledgeable sales representatives to get more information.

100 PSF LOADING

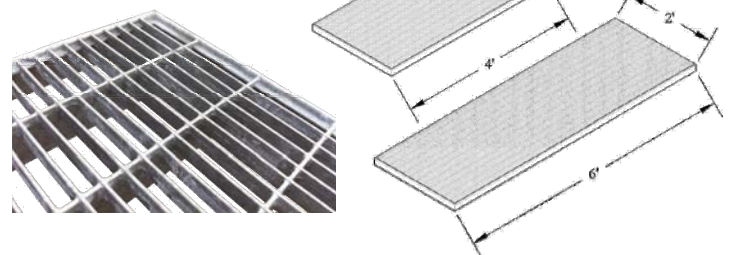



CONTRACTOR:
ENGINEER:

GPM TDH HP EFFIC.
SERVICE CONDITION: **STAGES**

MODEL
NPP16MFL

END USER:

PROJECT:

RPM
700

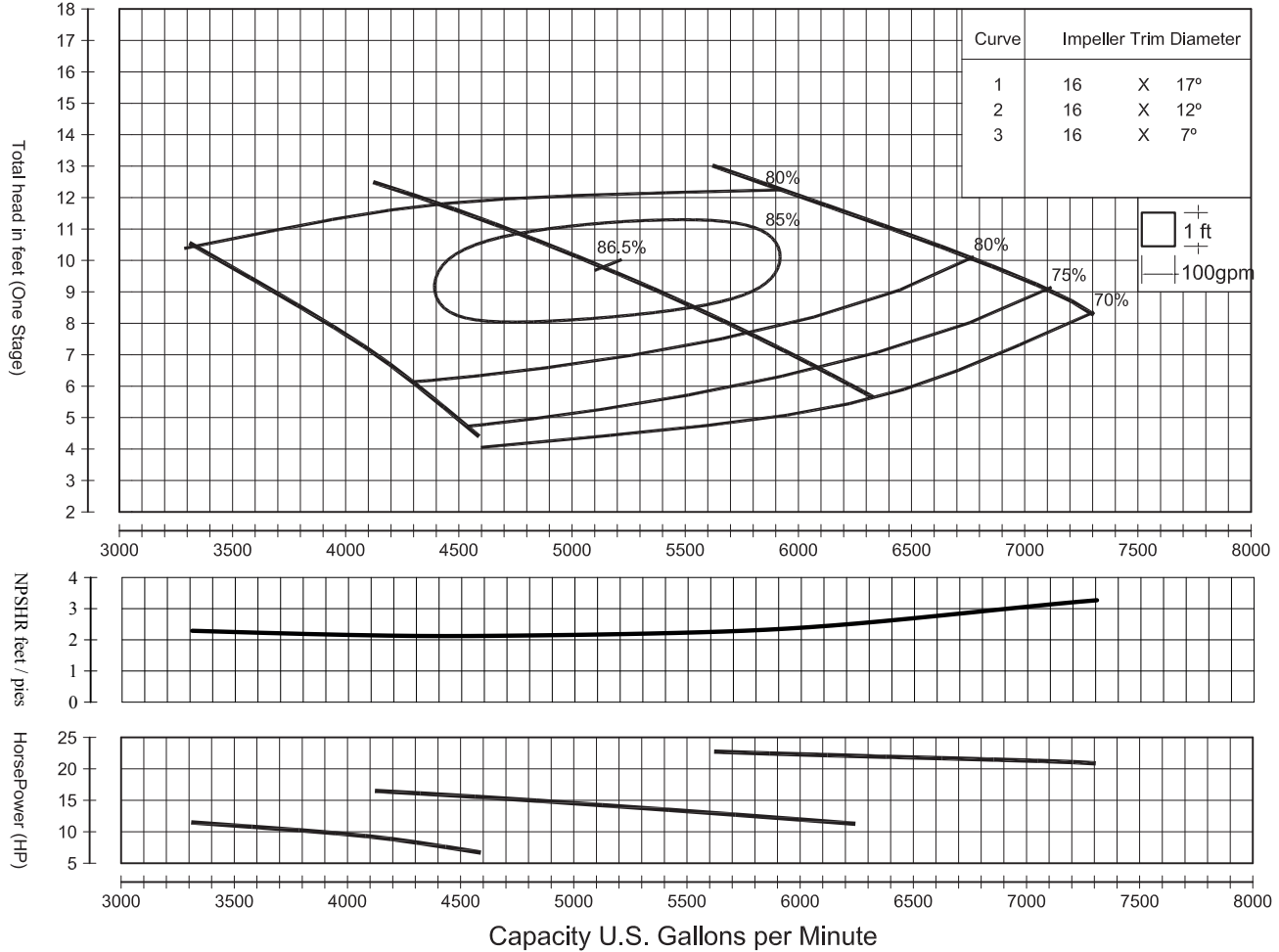

Std. Shaft Diameter	1.938"
Max. Shaft Diameter	2.000"
One Stage WT-LB	451.24
Add. Stage WT- LB	388.85
Impeller WT- LB	46.000
One Stage WR ² LB-FT ²	N/A
Impeller Type	SEMIOPEN
Impeller No.	TAT1418
Max. Sphere Size	2.250"
K-Factor, Max.	N/A
Max. Operating P.S.I	100
Min. Submergence	32"
Bolt Holes	16
Bolt Holes Diameter	.875

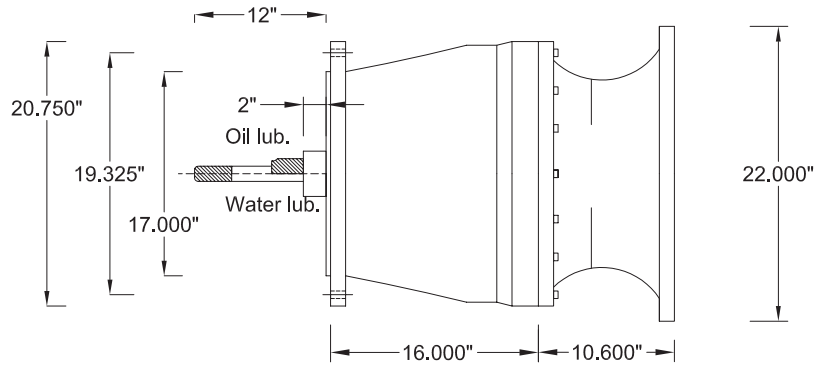

pumpandpond.com



CONTRACTOR:
ENGINEER:

GPM TDH HP EFFIC.
SERVICE CONDITION: **STAGES**

MODEL
NPP16MFH

END USER:

PROJECT:

RPM
700

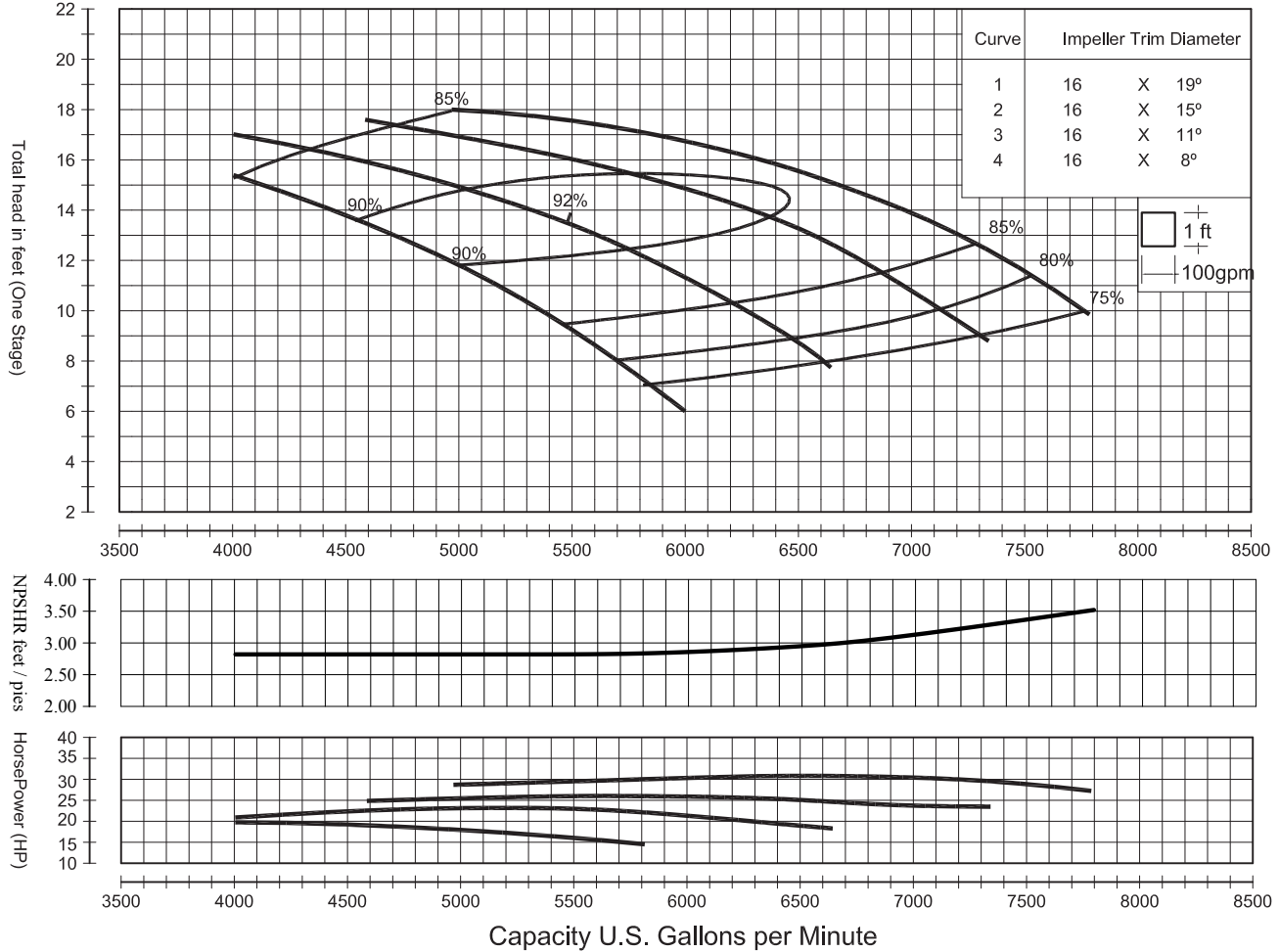

NPSHR feet / pies

HorsePower (HP)

Capacity U.S. Gallons per Minute

Std. Shaft Diameter	1.938"
Max. Shaft Diameter	2.000"
One Stage WT-LB	451.24
Add. Stage WT- LB	388.85
Impeller WT- LB	46.000
One Stage WR ² LB-FT ²	N/A
Impeller Type	SEMIOPEN
Impeller No.	TAT1428
Max. Sphere Size	2.250"
K-Factor, Max.	N/A
Max. Operating P.S.I	100
Min. Submergence	32"
Bolt Holes	16
Bolt Holes Diameter	.875

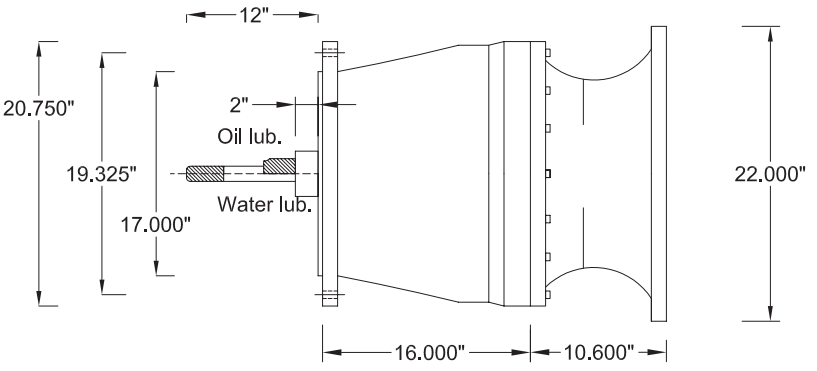

pumpandpond.com



CONTRACTOR:	GPM	TDH	HP	EFFIC.	MODEL NPP24MFL
	ENGINEER:			SERVICE CONDITION:	
END USER:	PROJECT:			RPM 880	

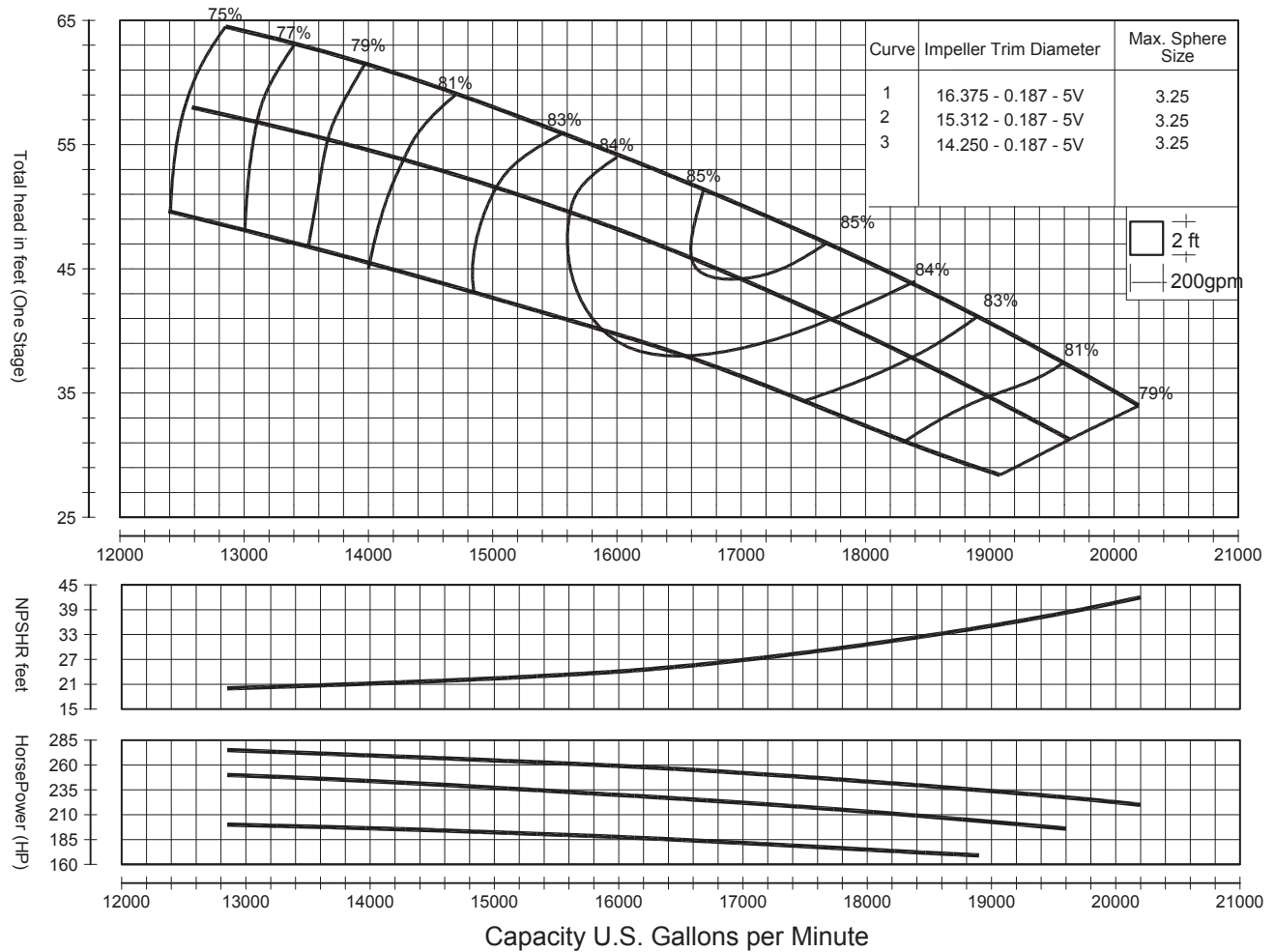

Std. Shaft Diameter	2.690"
Max. Shaft Diameter	3.000"
One Stage WT-LB	1780.0
Add. Stage WT- LB	1125.0
Impeller WT- LB	290.00
One Stage WR ² LB-FT ²	76
Impeller Type	SEMIOPEN
Impeller No.	TAT1417
K-Factor, Max.	125
Max. Operating P.S.I	125
Min. Submergence	59"
Bolt Holes	20
Bolt Holes Diameter	.810

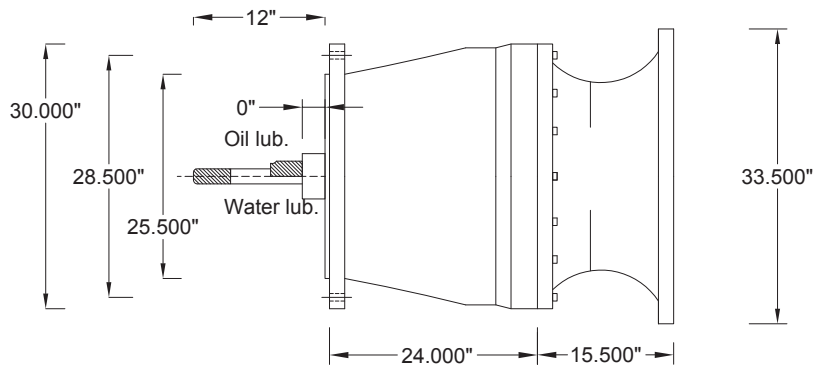

pumpandpond.com



CONTRACTOR:	GPM	TDH	HP	EFFIC.	MODEL NPP24MFM
	ENGINEER:			SERVICE CONDITION:	
END USER:	PROJECT:			RPM 880	

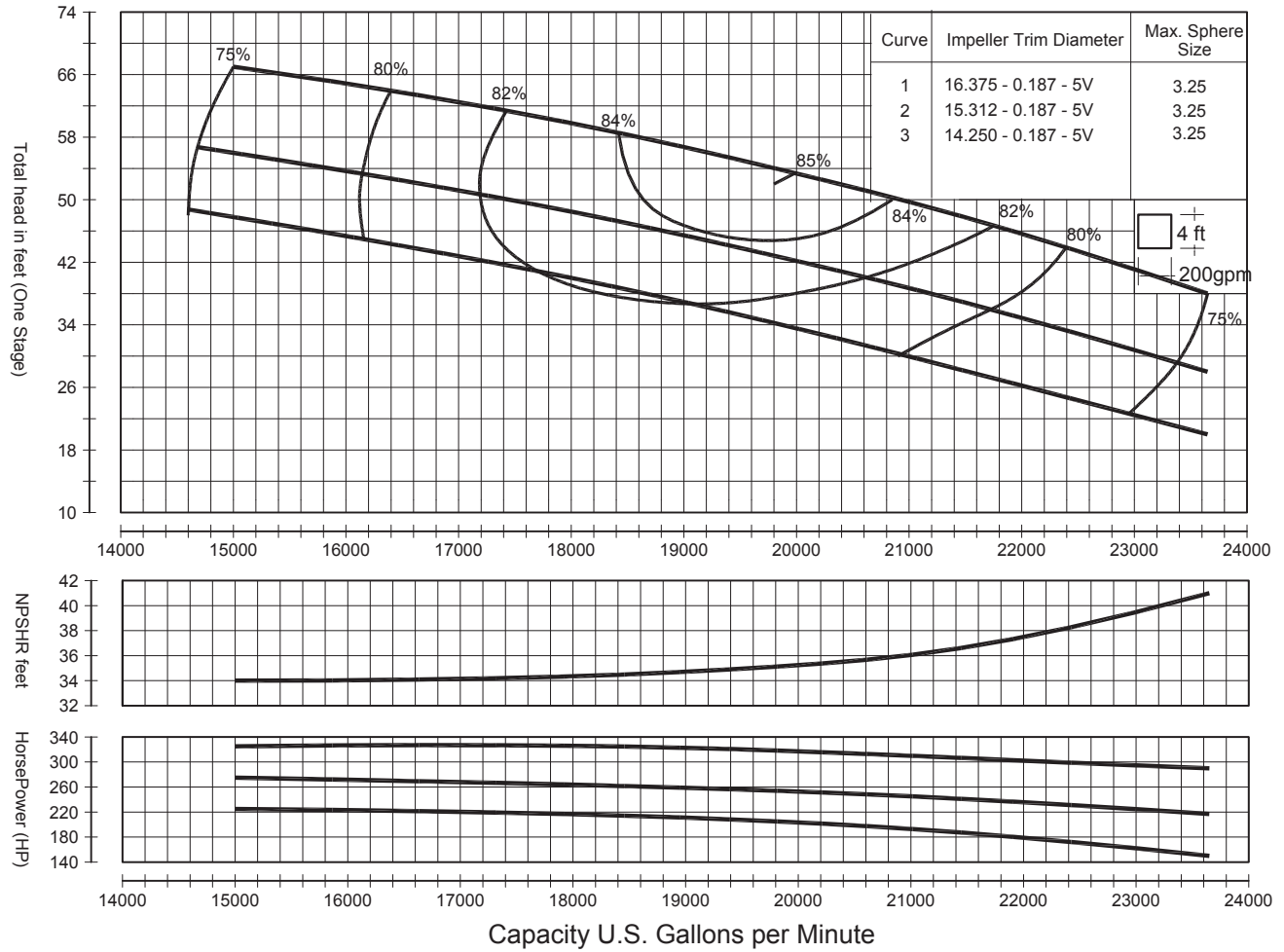

Std. Shaft Diameter	2.690"
Max. Shaft Diameter	3.000"
One Stage WT-LB	1780.0
Add. Stage WT- LB	1125.0
Impeller WT- LB	290.00
One Stage WR ² LB-FT ²	76
Impeller Type	SEMIOPEN
Impeller No.	TAT1427
K-Factor, Max.	125
Max. Operating P.S.I	125
Min. Submergence	59"
Bolt Holes	20
Bolt Holes Diameter	.810

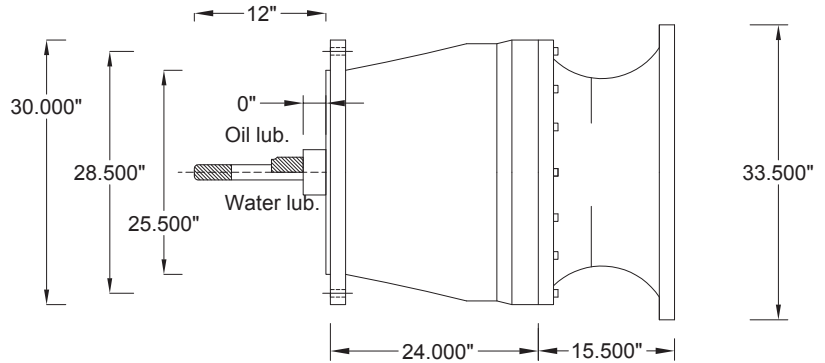

pumpandpond.com



CONTRACTOR:	GPM	TDH	HP	EFFIC.	MODEL NPP24MFH
	ENGINEER:			SERVICE CONDITION:	
END USER:	PROJECT:				RPM 880

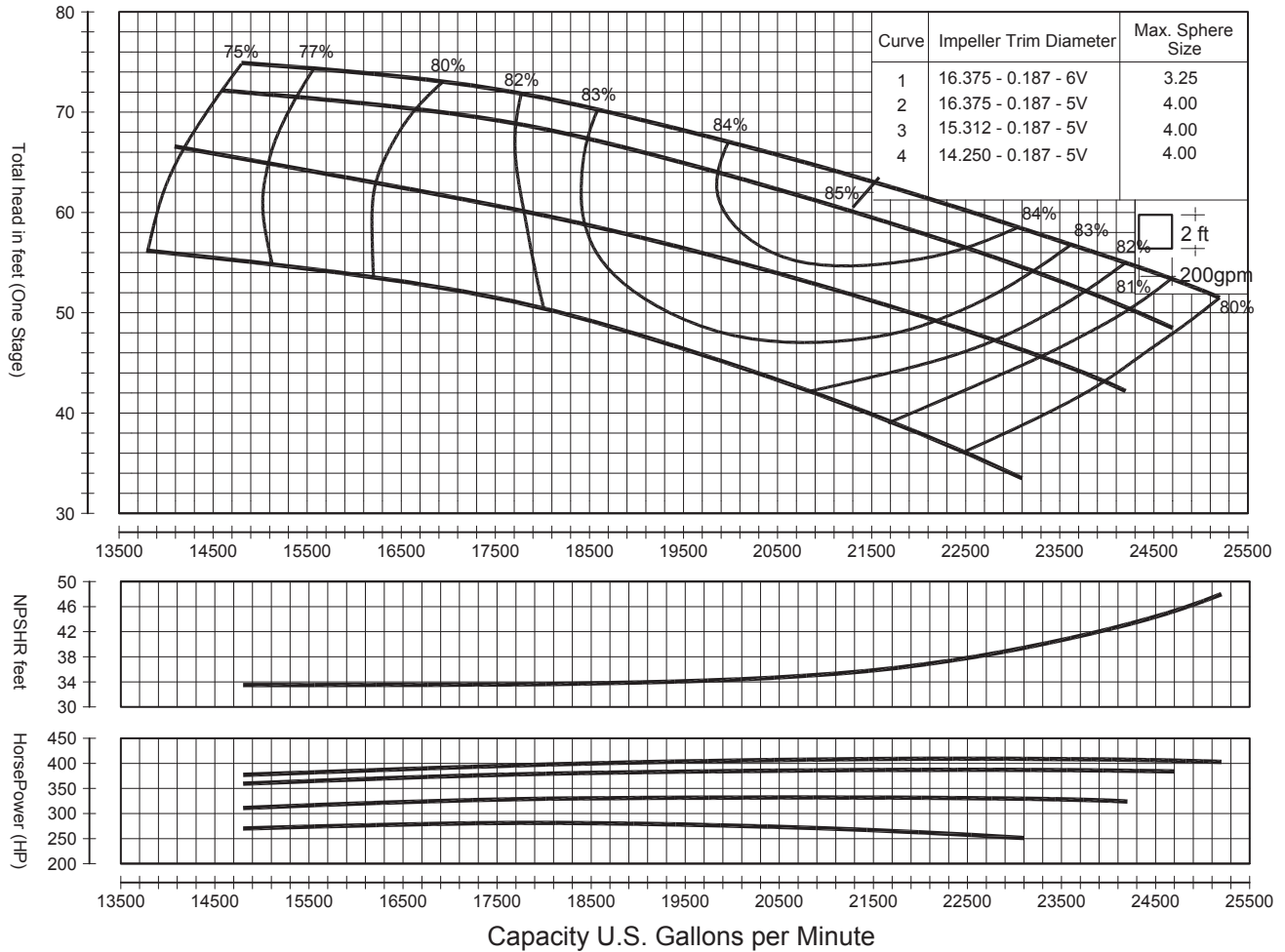

Std. Shaft Diameter	2.690"
Max. Shaft Diameter	3.000"
One Stage WT-LB	1780.0
Add. Stage WT- LB	1125.0
Impeller WT- LB	290.00
One Stage WR ² LB-FT ²	76
Impeller Type	SEMIOPEN
Impeller No.	TAT1437
K-Factor, Max.	125
Max. Operating P.S.I	125
Min. Submergence	59"
Bolt Holes	20
Bolt Holes Diameter	.810

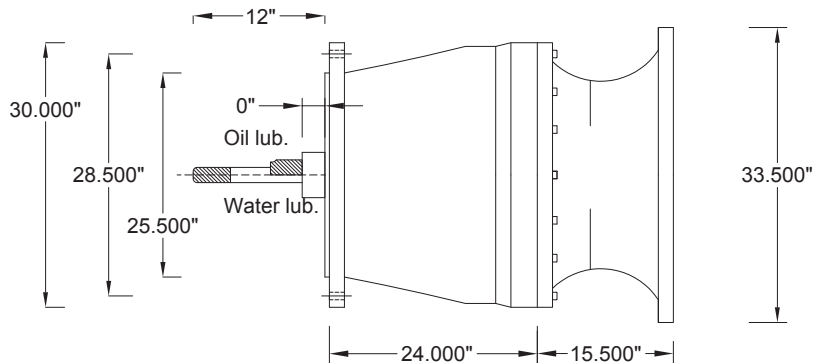

pumpandpond.com



CONTRACTOR:	GPM	TDH	HP	EFFIC.	MODEL NPP24MFL
	ENGINEER:			SERVICE CONDITION:	
END USER:	PROJECT:			RPM 705	

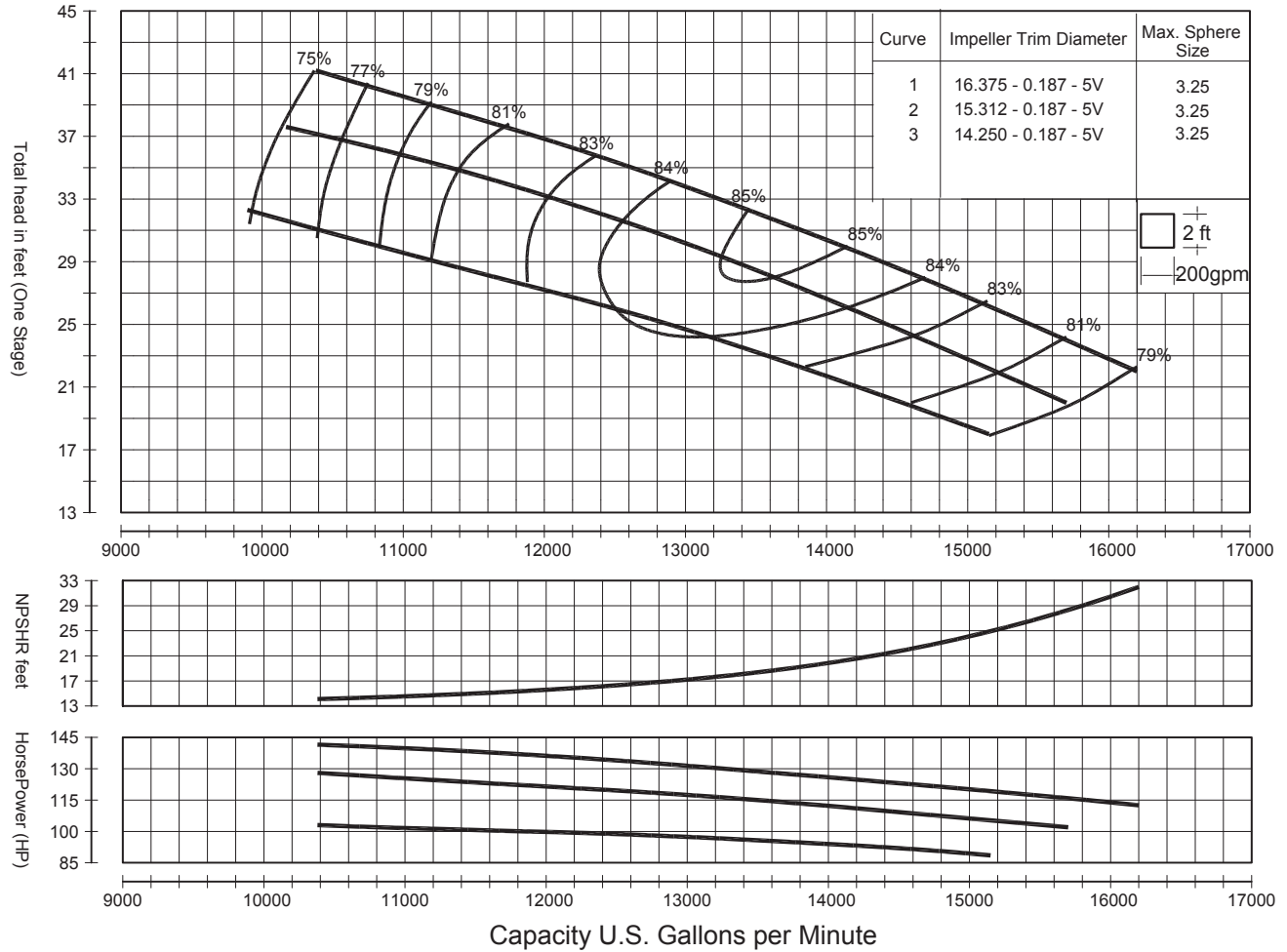

Std. Shaft Diameter	2.690"
Max. Shaft Diameter	3.000"
One Stage WT-LB	1780.0
Add. Stage WT- LB	1125.0
Impeller WT- LB	290.00
One Stage WR ² LB-FT ²	76
Impeller Type	SEMIOPEN
Impeller No.	TAT1417
K-Factor, Max.	125
Max. Operating P.S.I	125
Min. Submergence	59"
Bolt Holes	20
Bolt Holes Diameter	.810

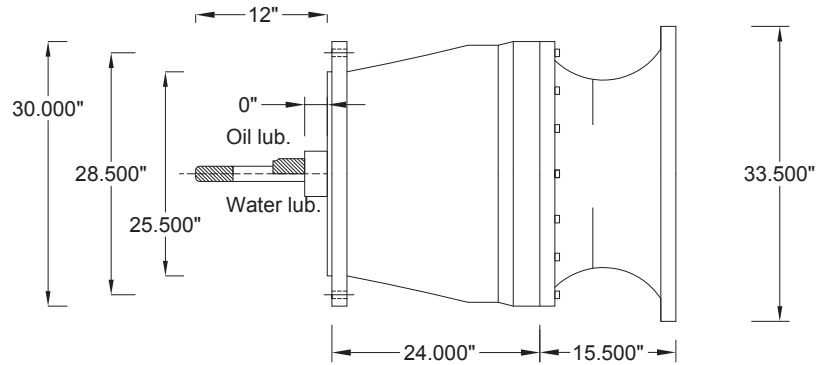



CONTRACTOR:	GPM	TDH	HP	EFFIC.	MODEL NPP24MFM
	ENGINEER:			SERVICE CONDITION:	
END USER:	PROJECT:			RPM 705	

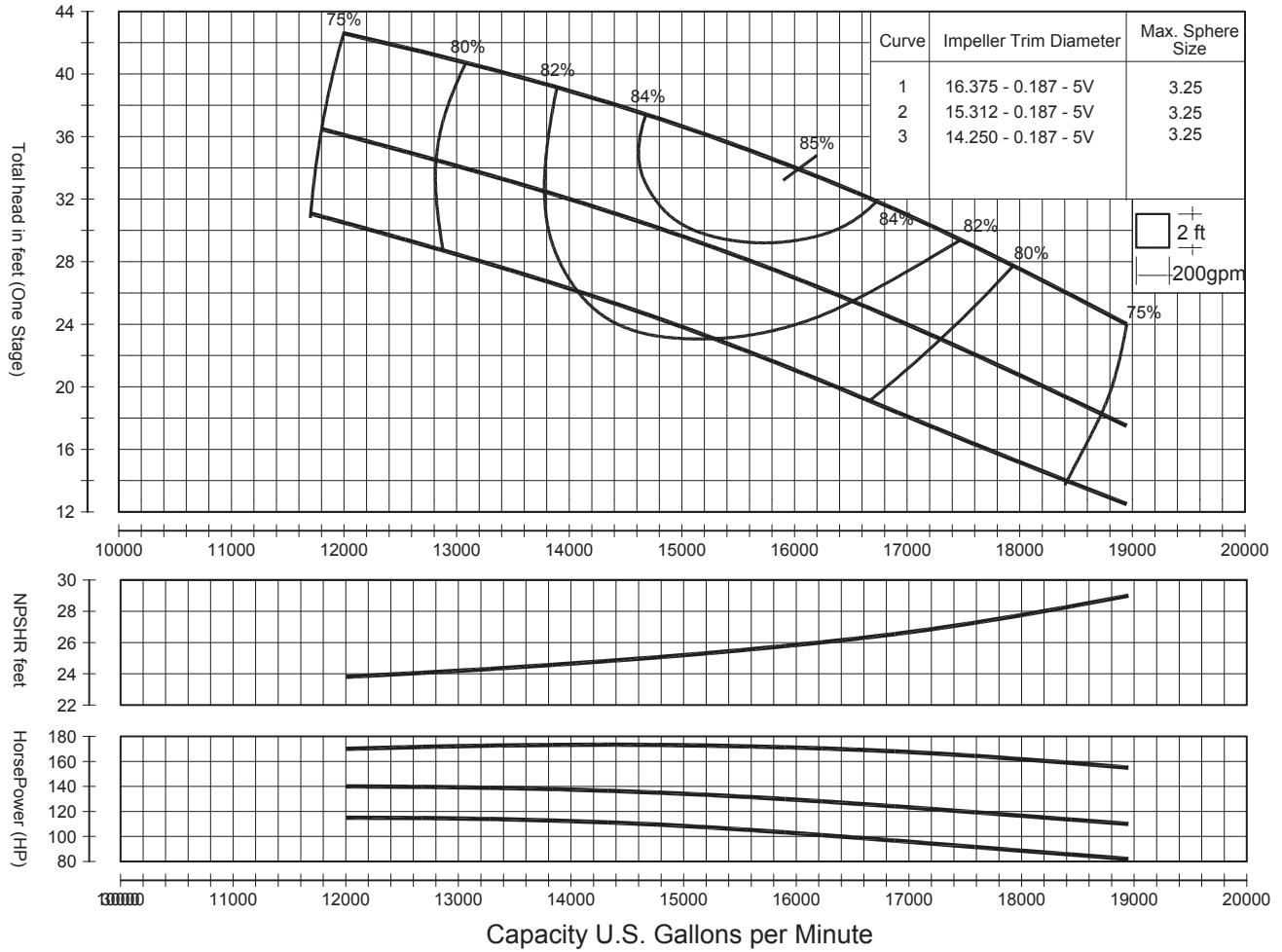

Std. Shaft Diameter	2.690"
Max. Shaft Diameter	3.000"
One Stage WT-LB	1780.0
Add. Stage WT- LB	1125.0
Impeller WT- LB	290.00
One Stage WR ² LB-FT ²	76
Impeller Type	SEMIOPEN
Impeller No.	TAT1427
K-Factor, Max.	125
Max. Operating P.S.I	125
Min. Submergence	59"
Bolt Holes	20
Bolt Holes Diameter	.810

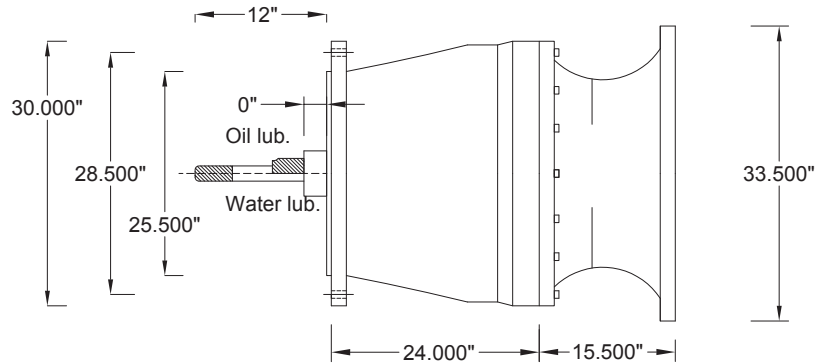

pumpandpond.com



CONTRACTOR:	GPM	TDH	HP	EFFIC.	MODEL NPP24MFH
	ENGINEER:			SERVICE CONDITION:	
END USER:	PROJECT:			RPM 705	

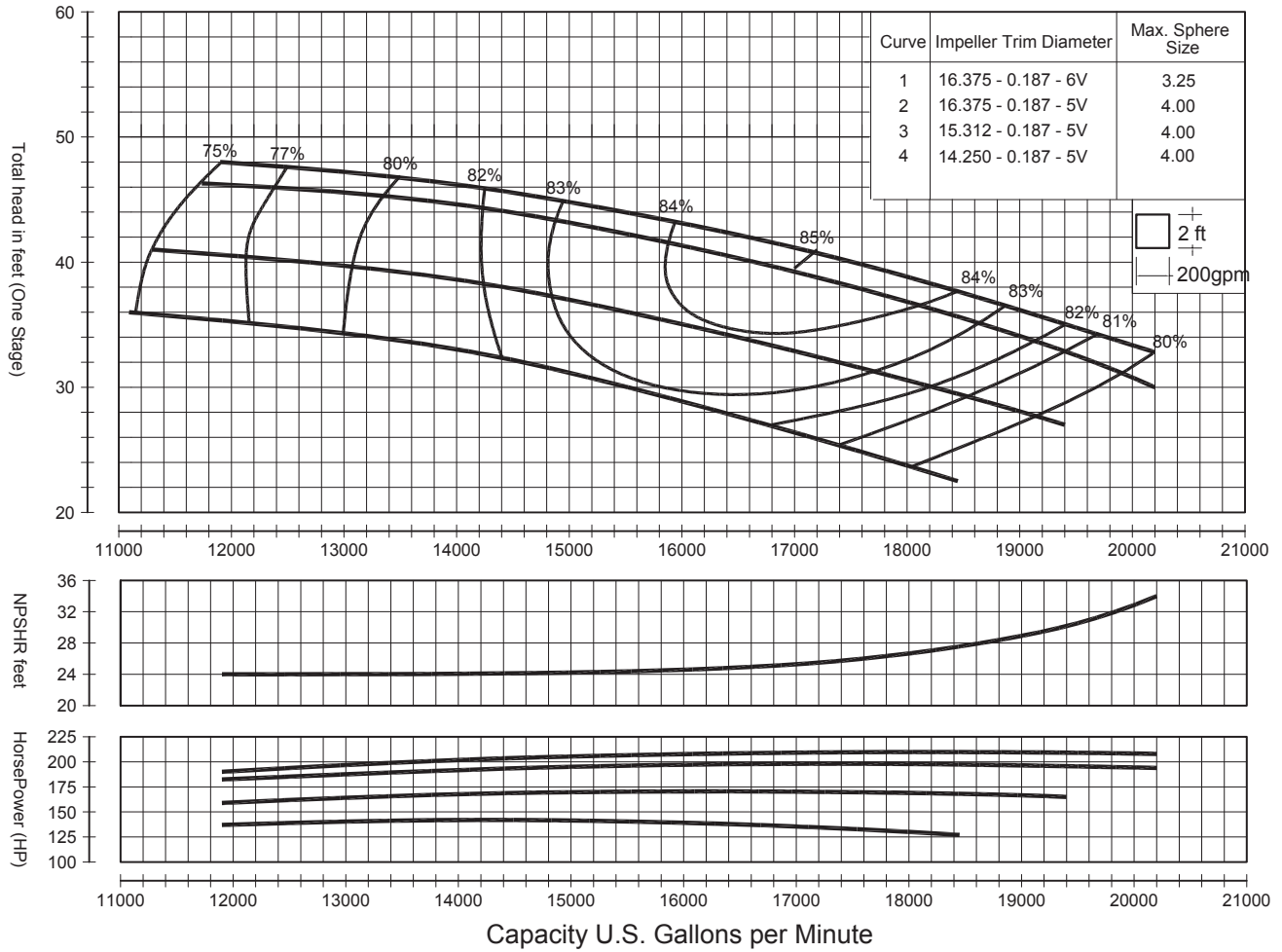

Std. Shaft Diameter	2.690"
Max. Shaft Diameter	3.000"
One Stage WT-LB	1780.0
Add. Stage WT- LB	1125.0
Impeller WT- LB	290.00
One Stage WR ² LB-FT ²	76
Impeller Type	SEMIOPEN
Impeller No.	TAT1437
K-Factor, Max.	125
Max. Operating P.S.I	125
Min. Submergence	59"
Bolt Holes	20
Bolt Holes Diameter	.810

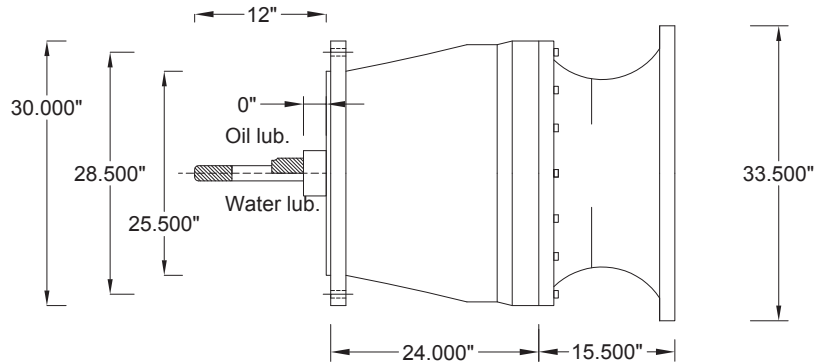

pumpandpond.com



CONTRACTOR:	GPM	TDH	HP	EFFIC.	MODEL NPP24MFL
	ENGINEER:			SERVICE CONDITION:	
END USER:	PROJECT:				RPM 590

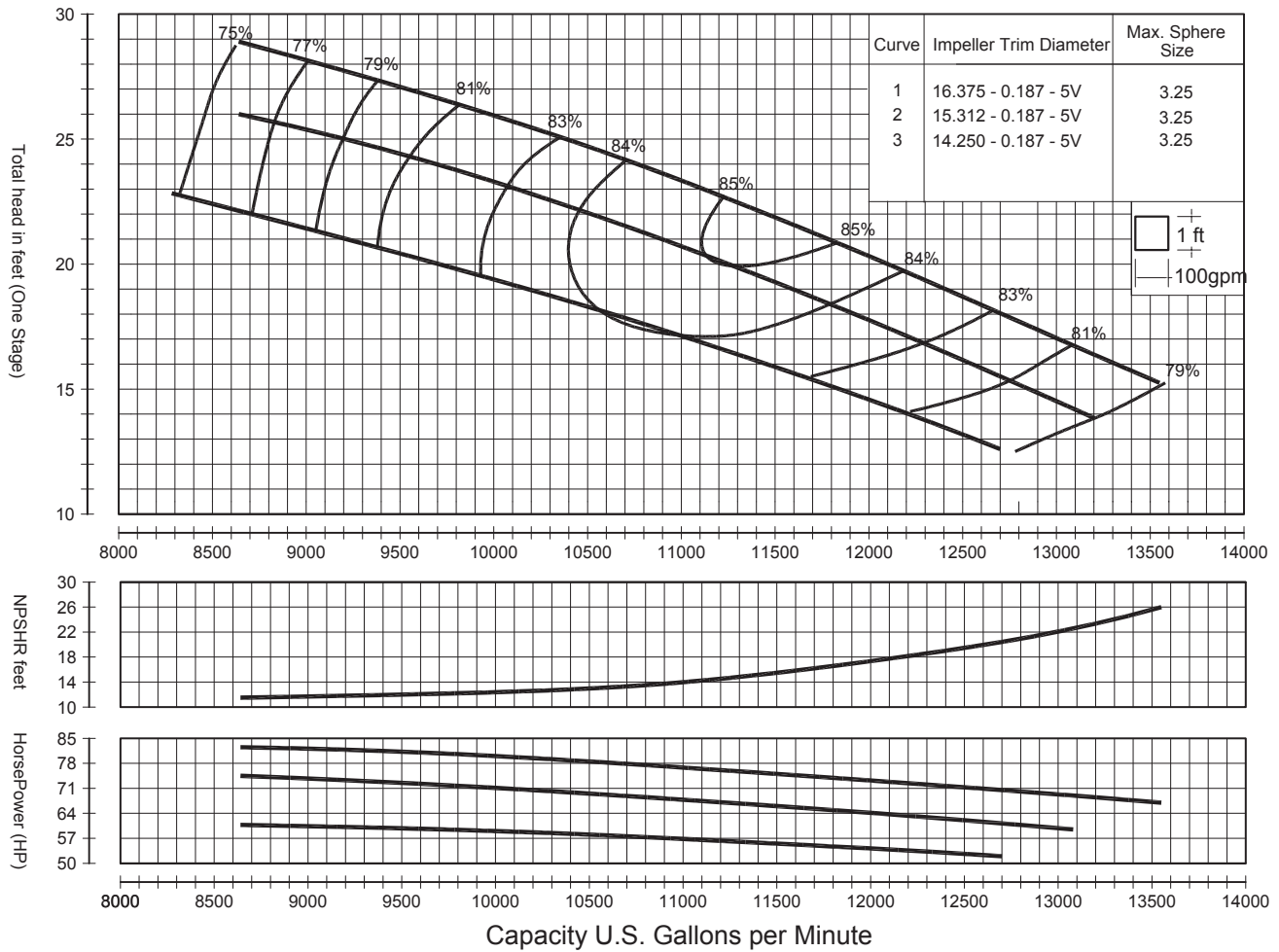

Std. Shaft Diameter	2.690"
Max. Shaft Diameter	3.000"
One Stage WT-LB	1780.0
Add. Stage WT- LB	1125.0
Impeller WT- LB	290.00
One Stage WR ² LB-FT ²	76
Impeller Type	SEMIOPEN
Impeller No.	TAT1417
K-Factor, Max.	125
Max. Operating P.S.I	125
Min. Submergence	59"
Bolt Holes	20
Bolt Holes Diameter	.810

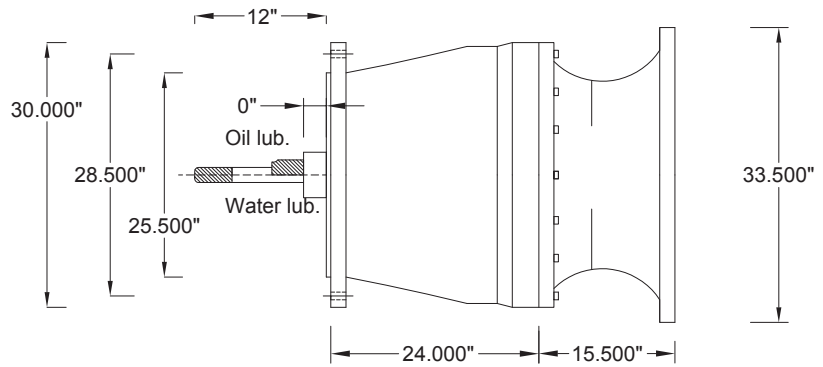

pumpandpond.com



CONTRACTOR:	GPM	TDH	HP	EFFIC.	MODEL NPP24MFM
ENGINEER:	SERVICE CONDITION:			STAGES	
END USER:	PROJECT:				RPM 590

Curva No. TAMFX24052 - 2007

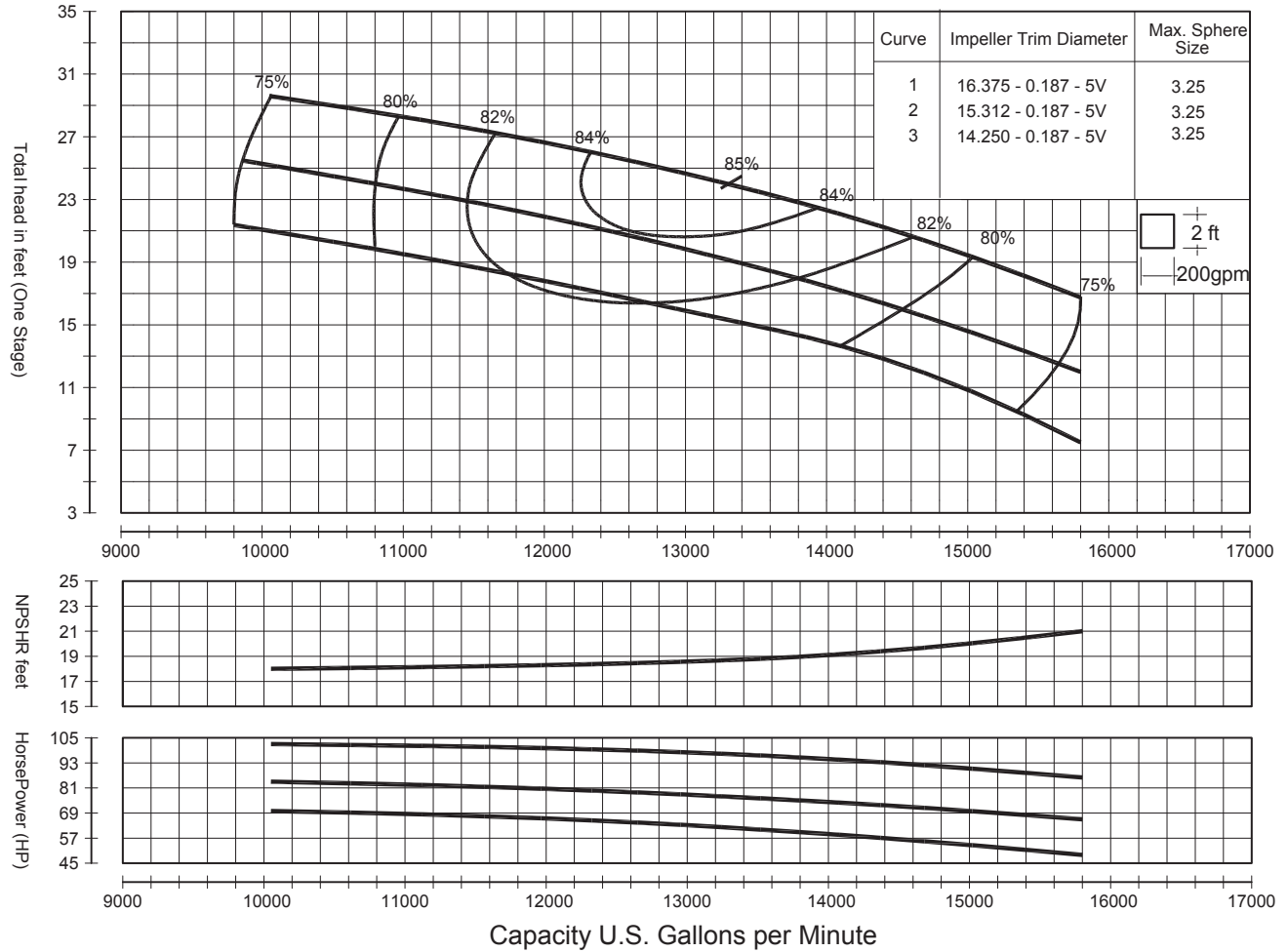

Std. Shaft Diameter	2.690"
Max. Shaft Diameter	3.000"
One Stage WT-LB	1780.0
Add. Stage WT- LB	1125.0
Impeller WT- LB	290.00
One Stage WR ² LB-FT ²	76
Impeller Type	SEMIOPEN
Impeller No.	TAT1427
K-Factor, Max.	125
Max. Operating P.S.I	125
Min. Submergence	59"
Bolt Holes	20
Bolt Holes Diameter	.810

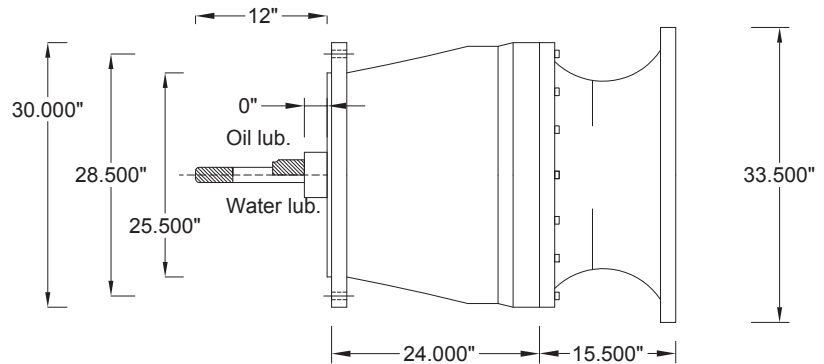

pumpandpond.com



CONTRACTOR:	GPM	TDH	HP	EFFIC.	MODEL NPP24MFH
ENGINEER:	SERVICE CONDITION:			STAGES	
END USER:	PROJECT:				RPM 590

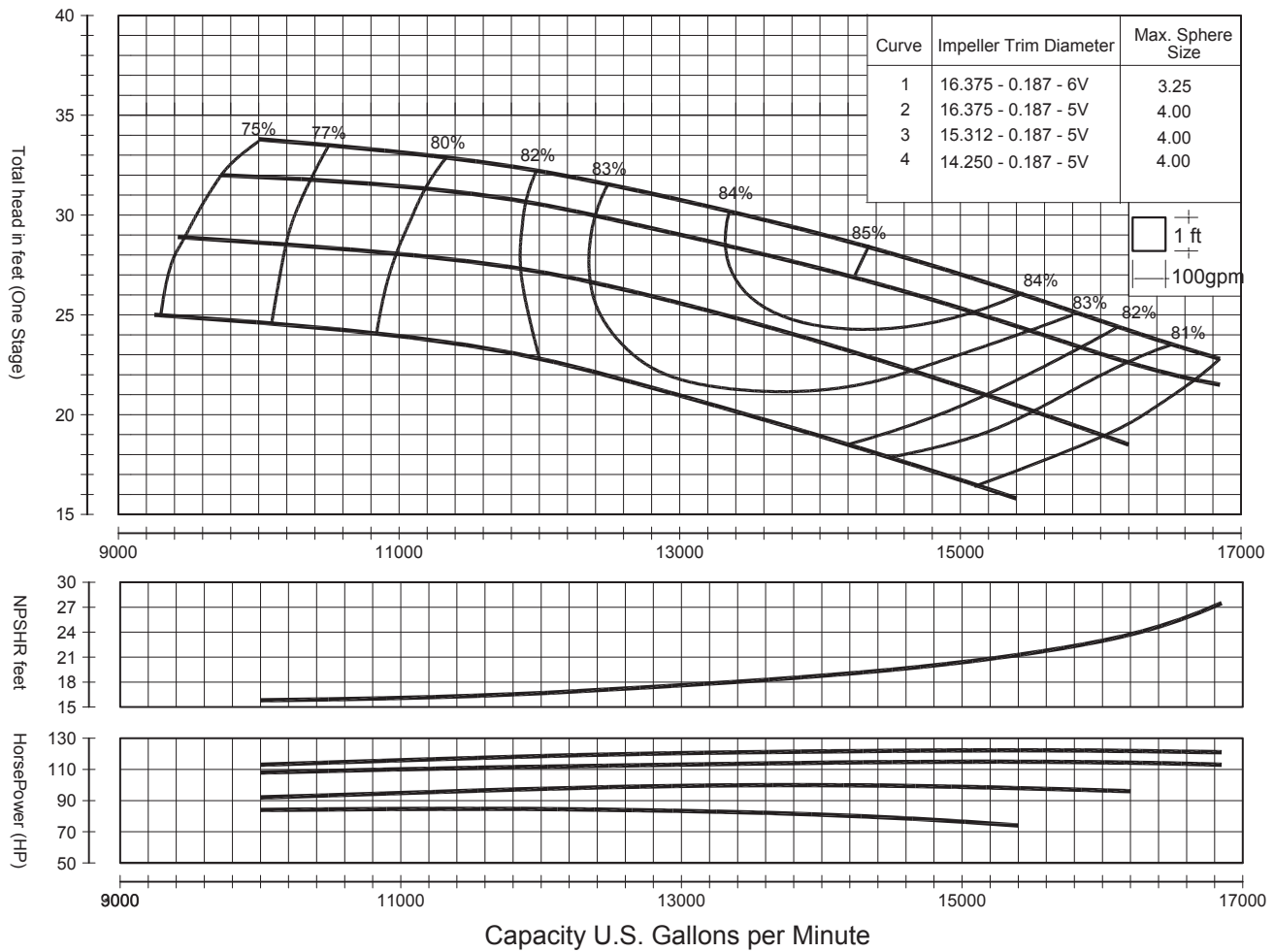

Std. Shaft Diameter	2.690"
Max. Shaft Diameter	3.000"
One Stage WT-LB	1780.0
Add. Stage WT- LB	1125.0
Impeller WT- LB	290.00
One Stage WR ² LB-FT ²	76
Impeller Type	SEMIOPEN
Impeller No.	TAT1437
K-Factor, Max.	125
Max. Operating P.S.I	125
Min. Submergence	59"
Bolt Holes	20
Bolt Holes Diameter	.810

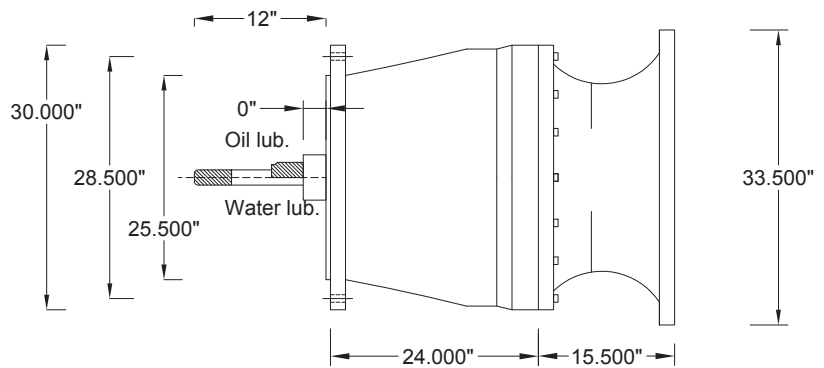

pumpandpond.com



MIXED FLOW BELOW GRADE

APPLICATIONS:

- Transfer & supply water from lakes, rivers, retention ponds, geothermals & aquifers
- Potable Water
- Irrigation
- High Volume Booster
- Waste Water
- Flood Control
- Dewatering

Flows: up to 24,000 gpm

Total Dynamic Head: 0 - 200 feet

Discharge Designs: Above or Below Surface

STANDARD FEATURES:

- Standard Bronze or Stainless Steel Impellers
- Standard all Stainless Steel Bolting & Collets
- Standard Specialty bearings

ADDITIONAL FEATURES:

- Low NPSH Design
- Solids passage 1.5" to 4" depending on model
- Floating stations available

Material options for use with clean water, salt water, mine water, brines, and corrosives.

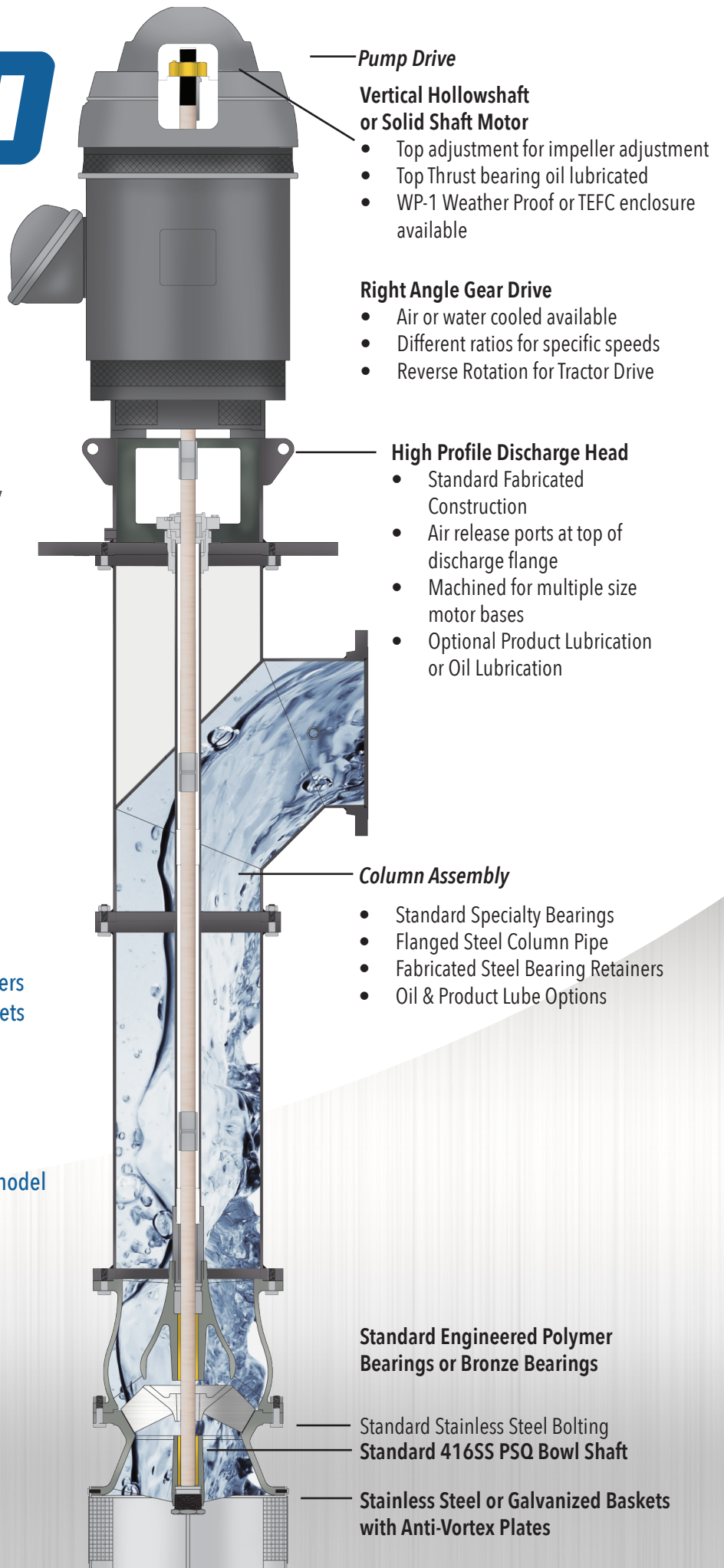



WWW.PUMPANDPOND.COM
615.336.8405 | info@pumpond.com